

DETAILS

Product Number	CN12483_MIRELLA-50-S-DL
Family	Mirella
Type	RefPack
Color	metal
Diameter	49,9 mm
Height	23,9 mm
Style	round
Optic Material	PC
Holder Material	
Fastening	glue
Status	production ready
ROHS Compliant	Yes
Date Updated	21/04/2016

OPTICAL PROPERTIES

LED	Viewing	Light	Effi-		Connector
	Angle	Beam	ciency	cd/lm	
Soleriq S9	sim: 21	Spot	sim: 86 %	sim: 3.400	-
CXA/B 13xx	15 deg	Spot	81 %	5.400	-
COB 4W	17 deg	Spot	86 %	4.400	-
XHP50	17 deg	Spot	85 %	4.100	-
BXRA LS	18 deg	Spot	83 %	4.000	-
NSCxL036A	19 deg	Spot	84 %	4.200	-
XHP70	19 deg	Spot	86 %	4.000	-
CLL01x	20 deg	Spot	-	sim: 0.000	-
MT-G2	20 deg	Spot	85 %	3.700	-
Mini Zenigata (GW5BM)	20 deg	Spot	86 %	3.500	-
CXA/B 15xx	20 deg	Spot	90 %	3.100	-
Mini Zenigata (GW6BM)	20 deg	Spot	84 %	3.200	-
STARK SLE PURE G3 LES10	20 deg	Spot	83 %	3.800	-
MHD-E/G	20 deg	Spot	88 %	3.300	-
Duris S10	20 deg	Spot	81 %	3.400	-
LUXEON S1000	21 deg	Spot	-	sim: 0.000	-
ZC4/6	21 deg	Spot	83 %	3.400	-
CLU700	21 deg	Spot	84 %	3.100	-
NSBxL066A/NFCxL036B	23 deg	Spot	86 %	3.200	-
LUXEON CoB 1202/1203	23 deg	Spot	85 %	3.100	-
CXM-9	24 deg	Spot	84 %	2.700	-
CXA/B 1816 & CXA/B 1820 & CXA 1850	26 deg	Spot	83 %	2.600	-
CLU710	26 deg	Spot	83 %	2.100	-
CLL02x/CLU02x (LES10)	28 deg	Spot	82 %	2.130	-
Soleriq S13	30 deg	Spot	83 %	2.100	-



Relative intensity of CN12483_MIRELLA-50-S-DL_(CXA1304)

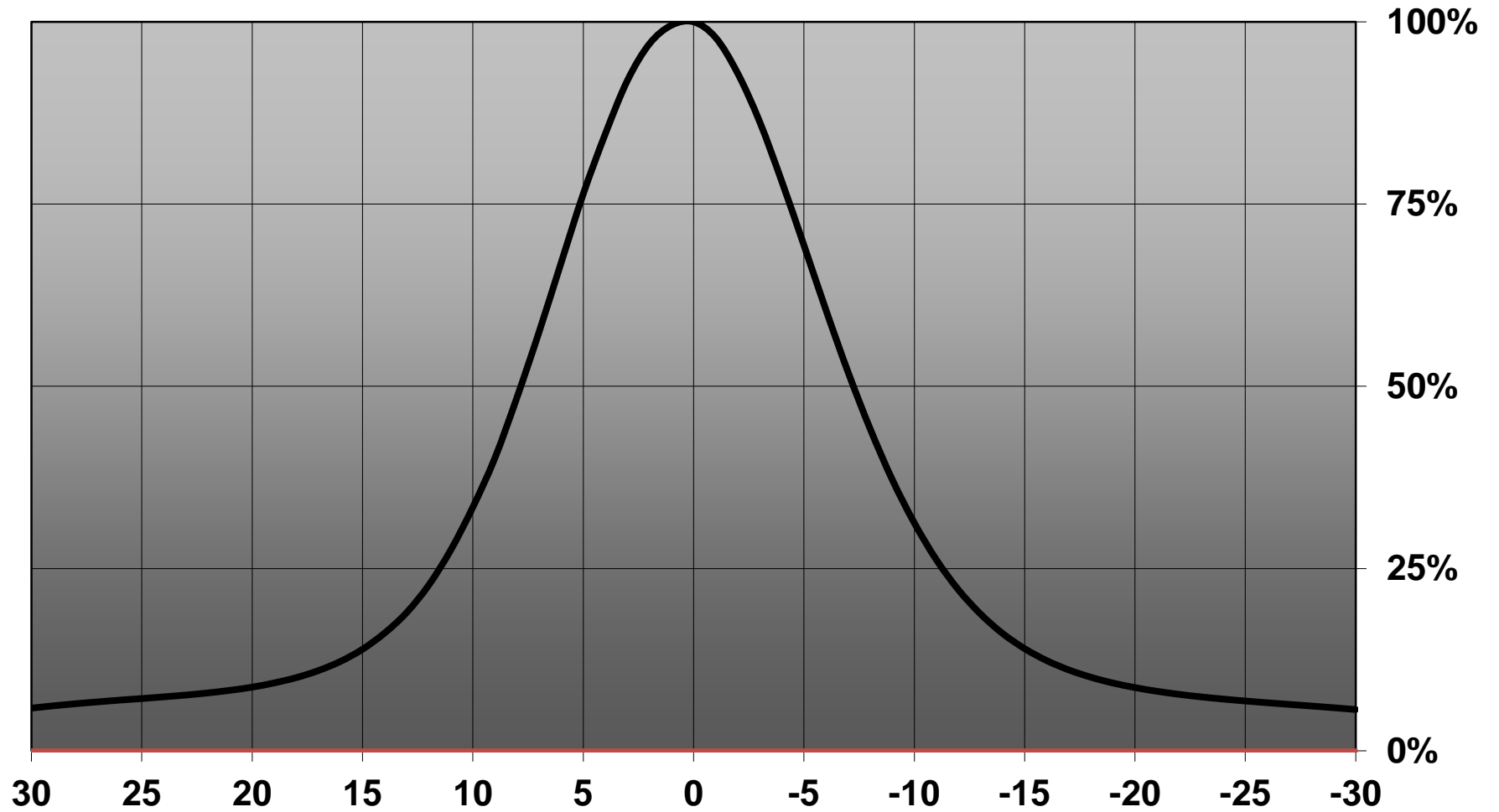

Relative intensity of Mirella-S-DL-4WLG

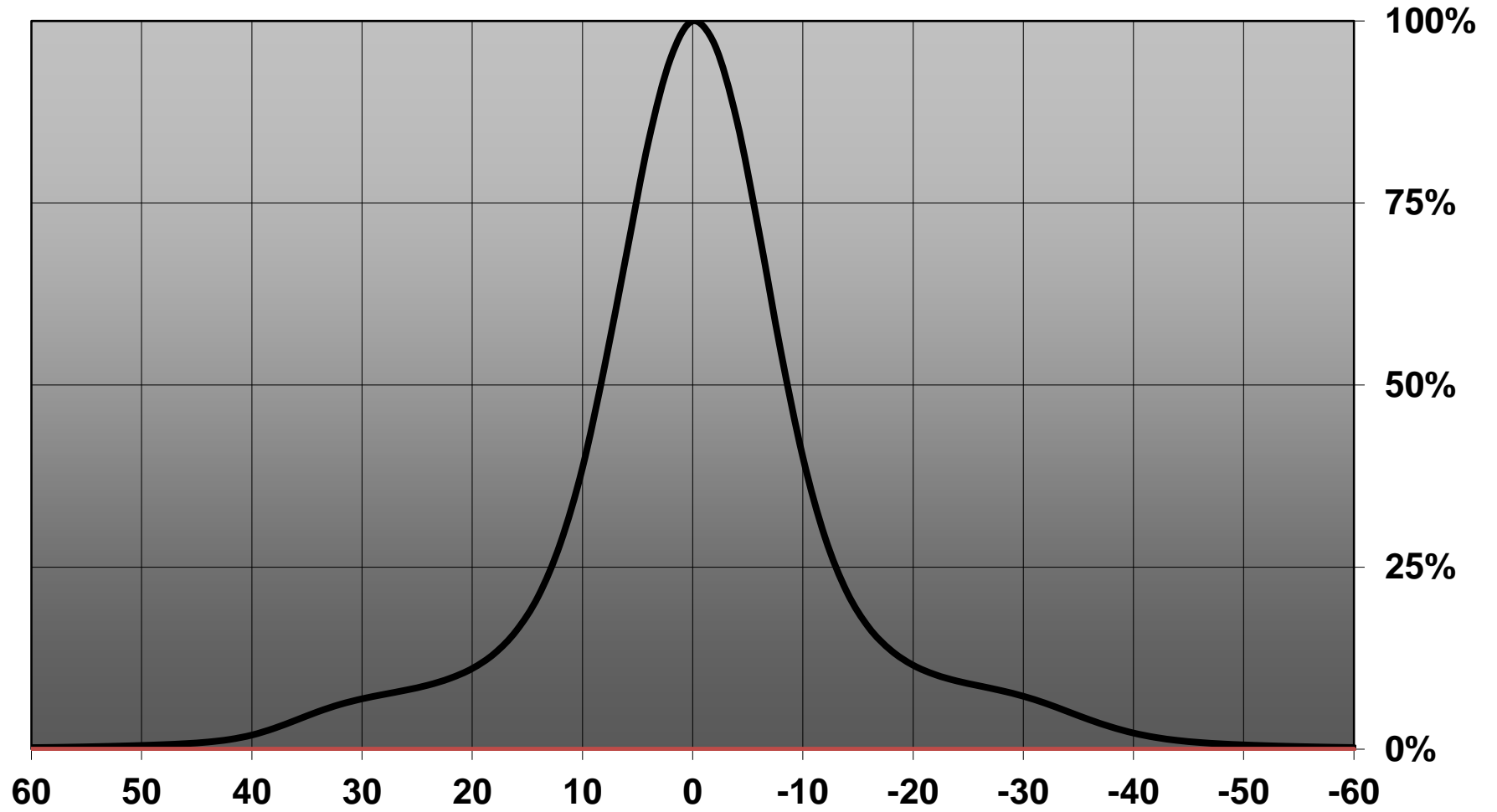

Relative intensity of CN12483_MIRELLA-50-S-DL_(CLL010)

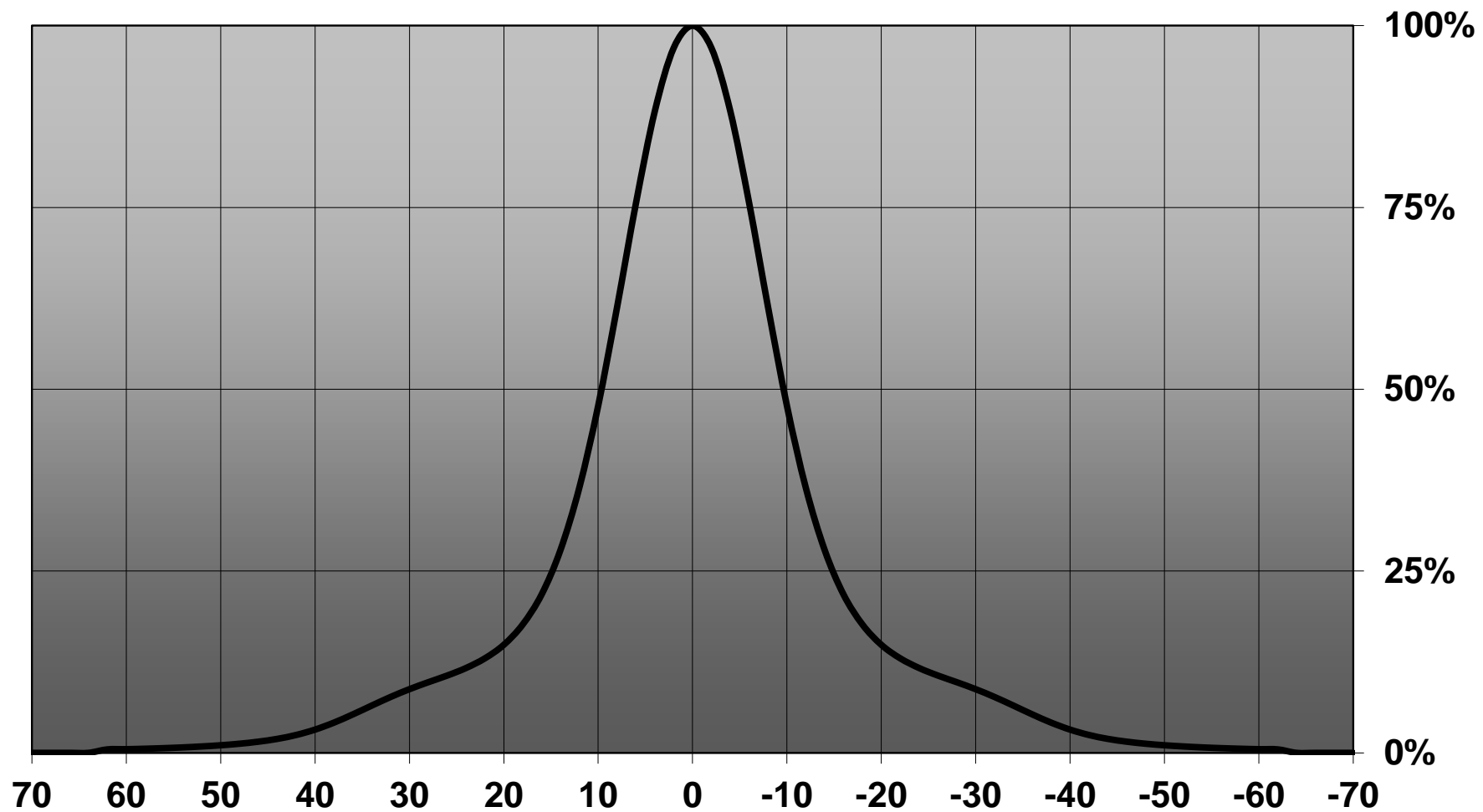

Relative intensity of CN12483_MIRELLA-50-S-DL_(MTG_Gen_II)

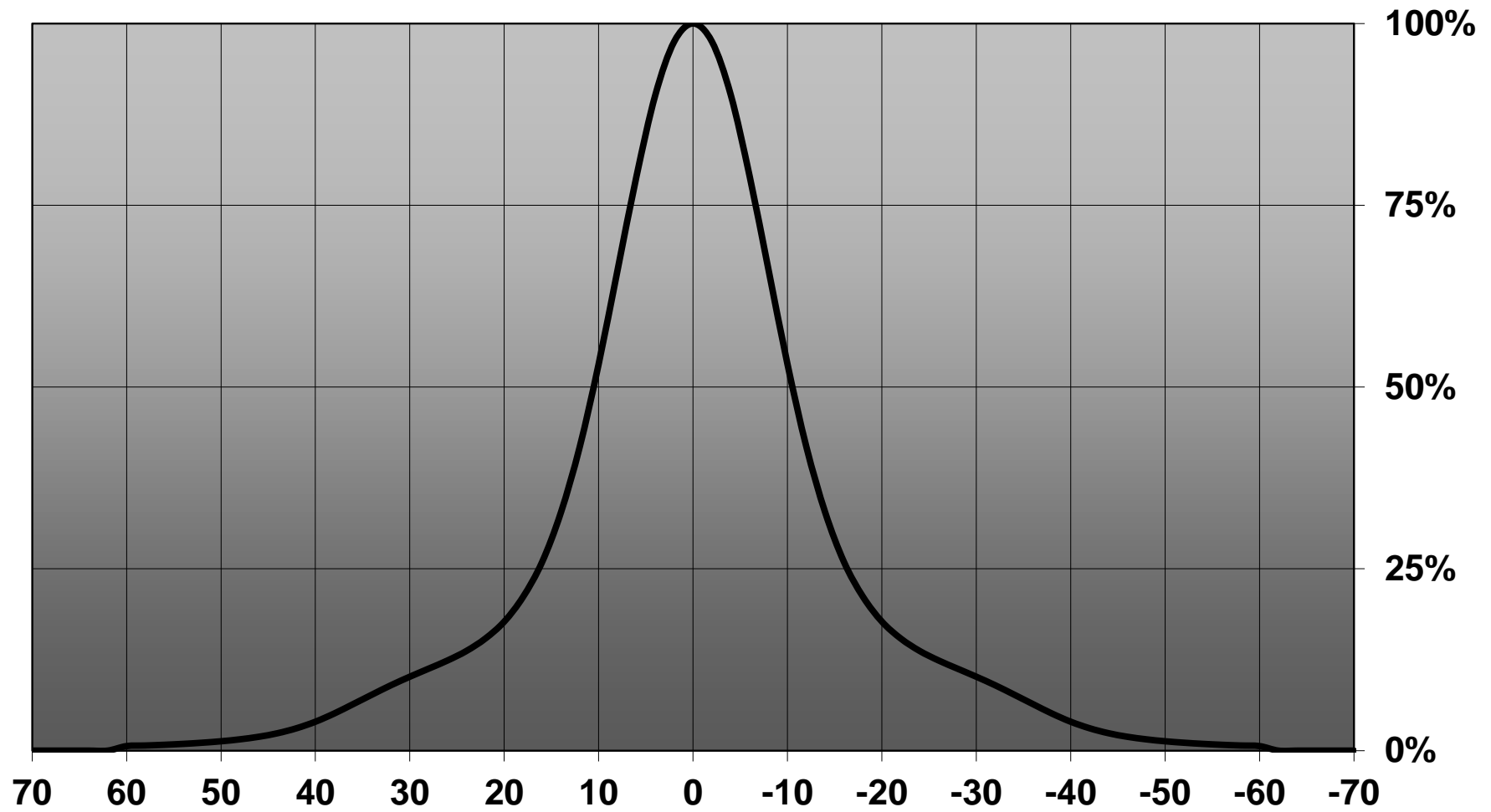

Relative intensity of CN12483_MIRELLA-50-S-DL

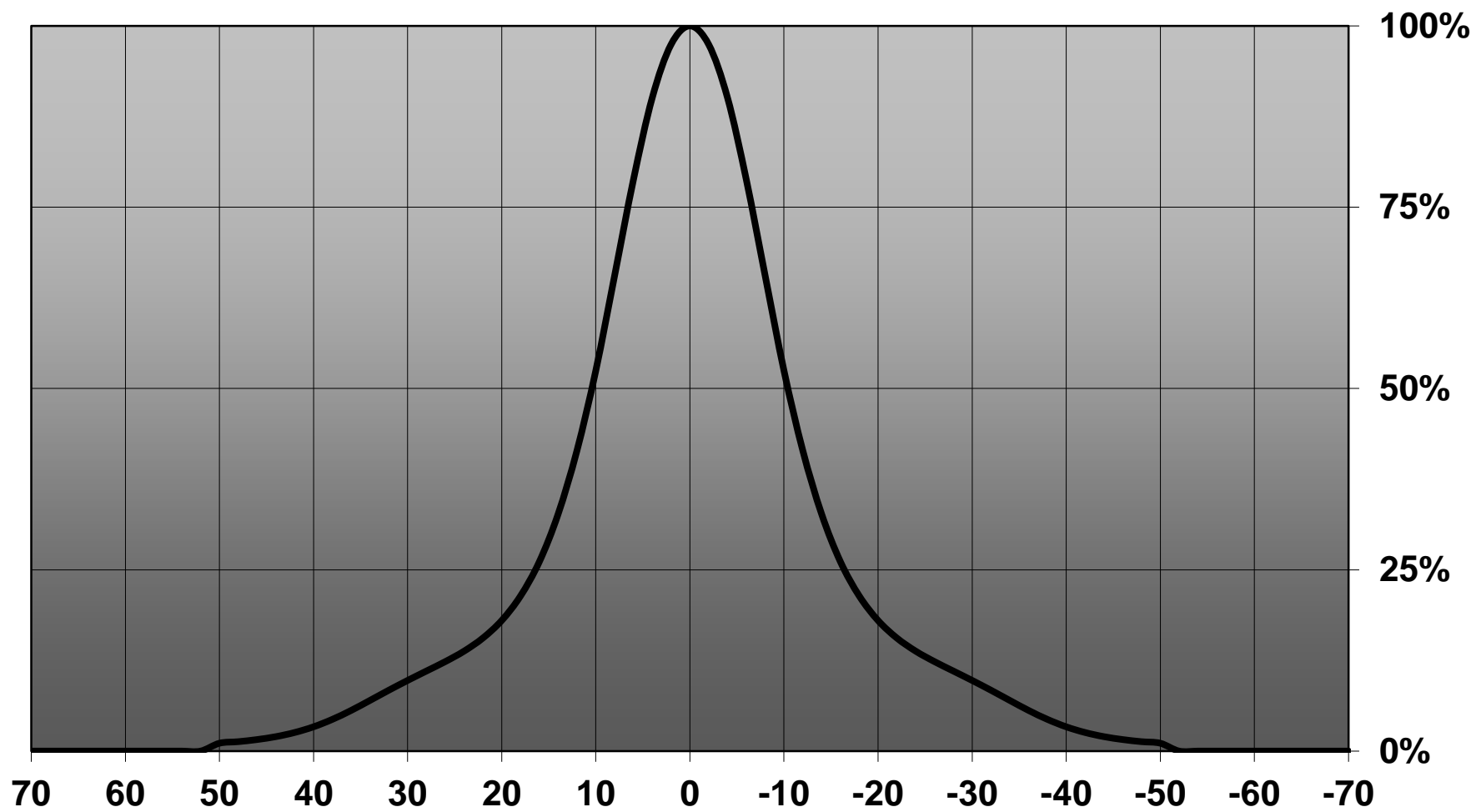

Relative intensity of CN12483_MIRELLA-50-S-DL_(Duris_S10)

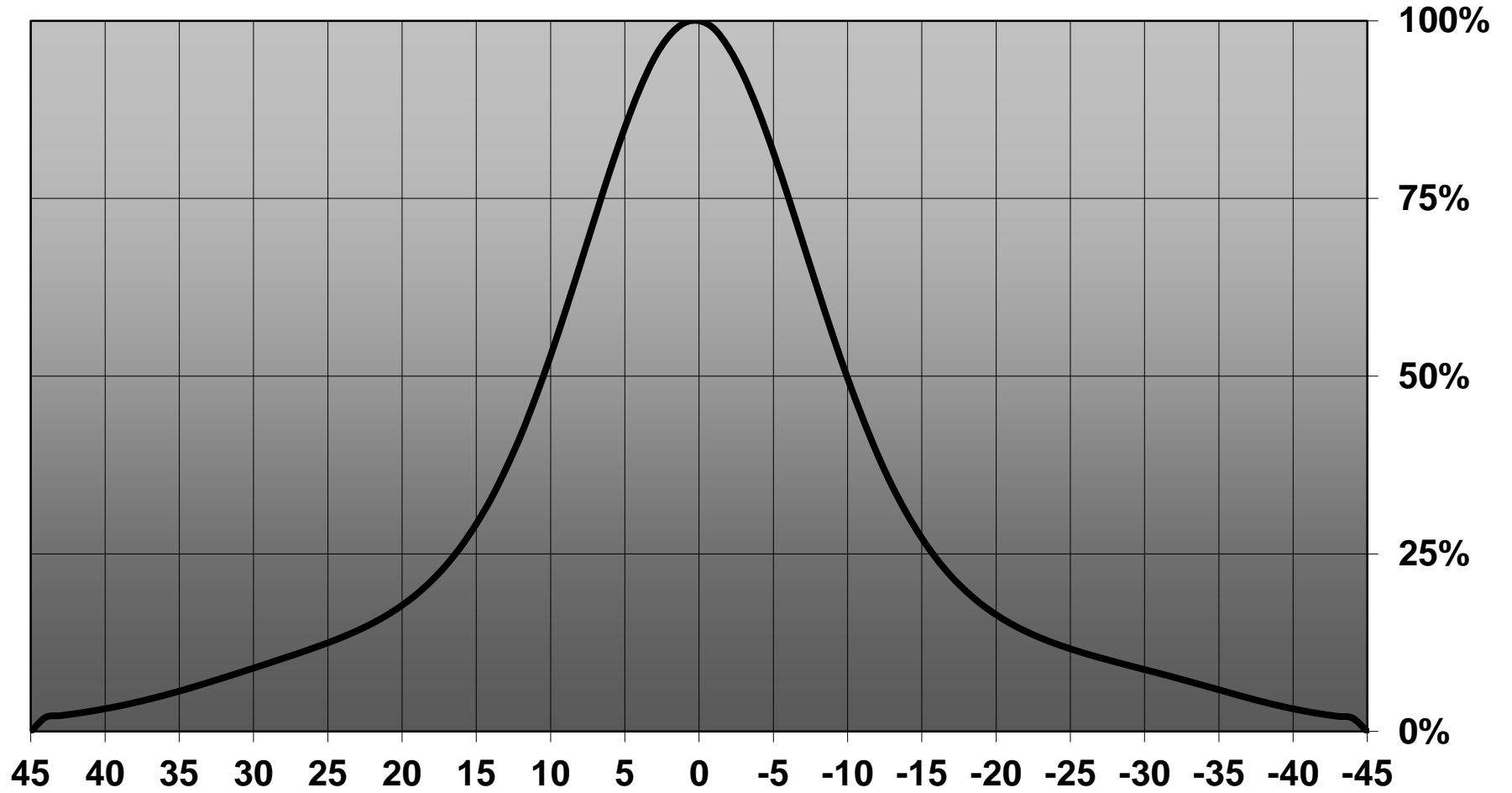

Relative intensity of CN12483_MIRELLA-50-S-DL_(Luxeon_S)

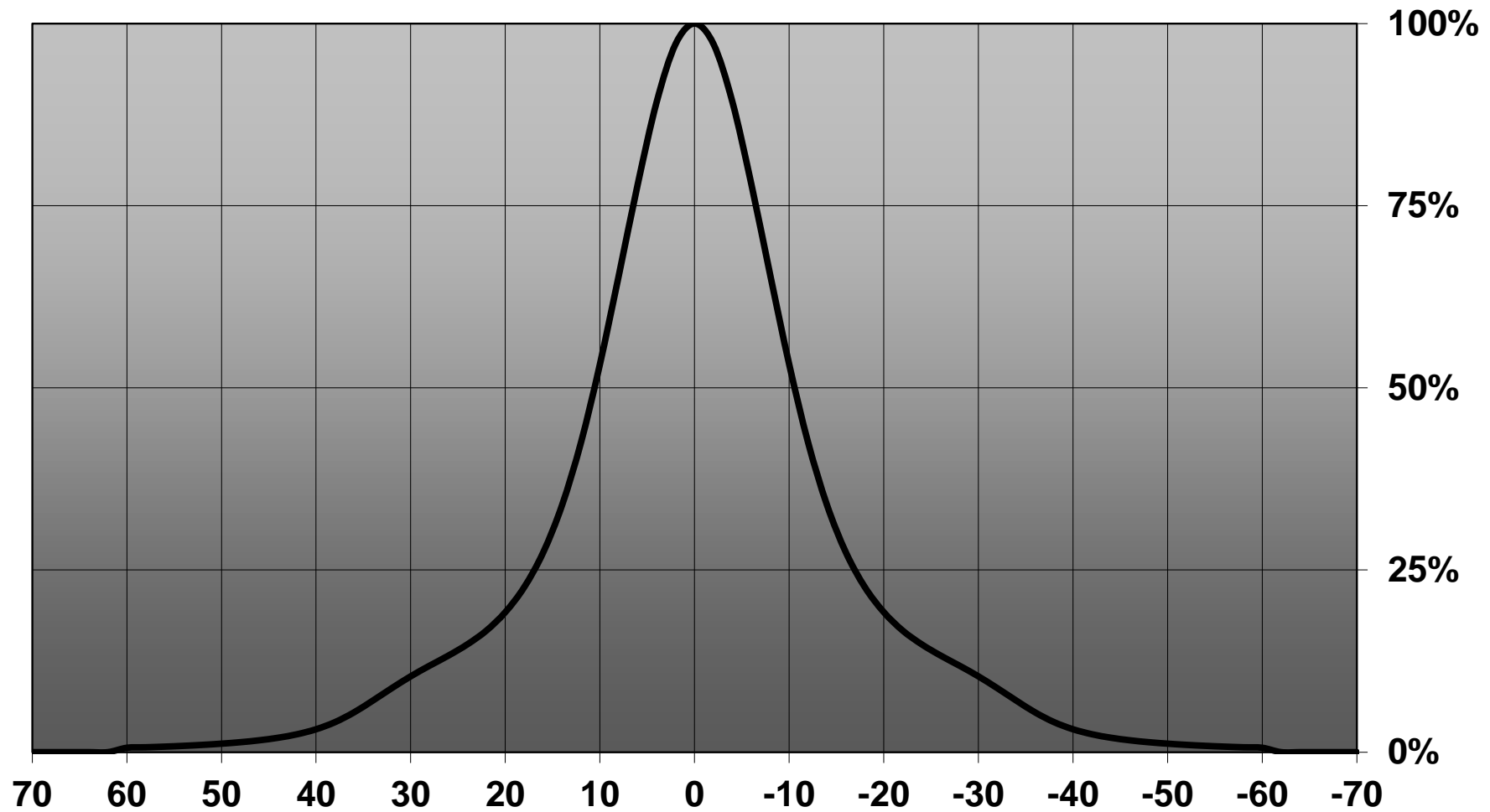

Relative intensity of CN12483_MIRELLA-50-S-DL_(CXA1816)

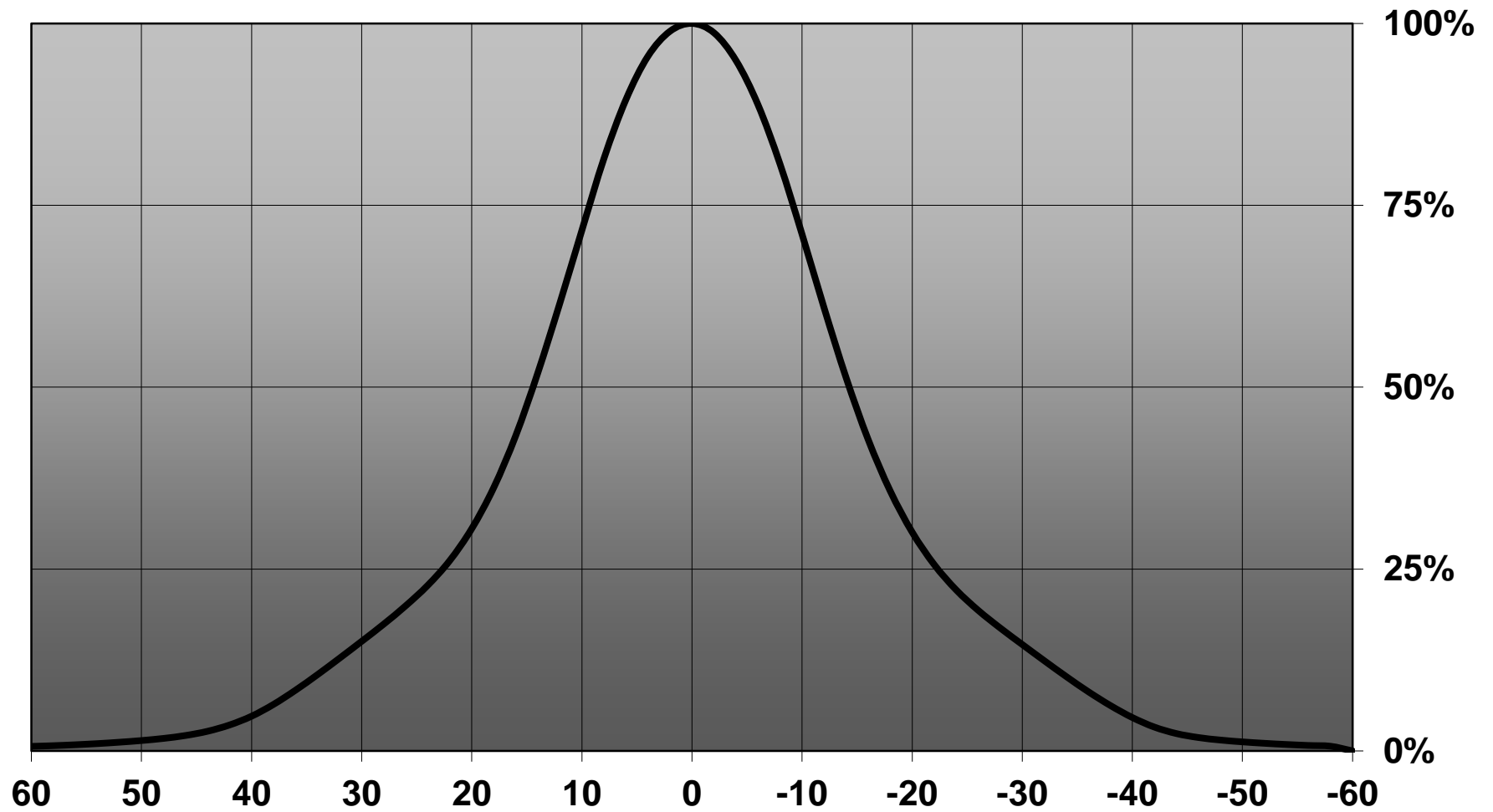

D

C

B

A

4

4

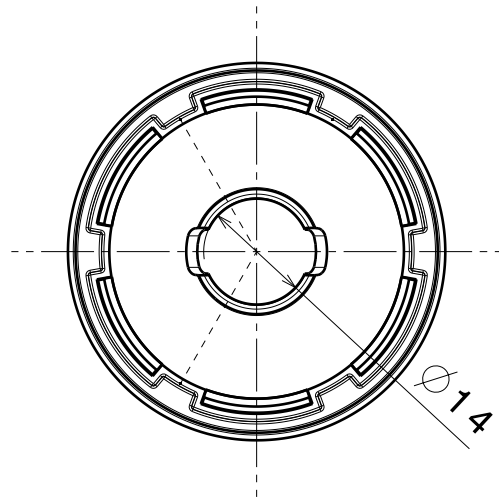
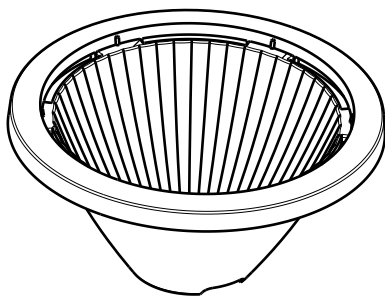

3

3

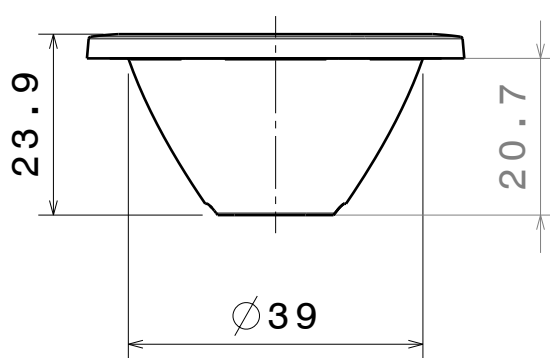
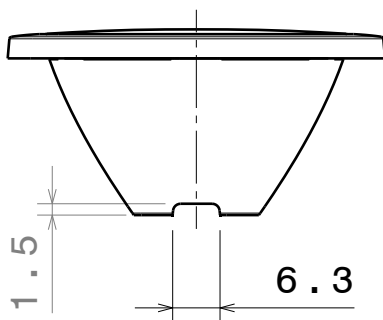

2

2

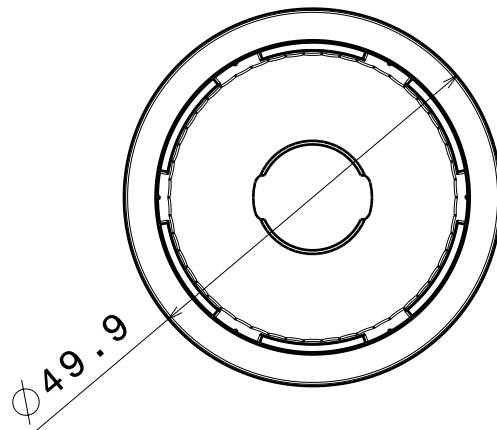

Material: PC, metal plated

This drawing is our property.
It can't be reproduced
or communicated without
our written agreement.



Ledil Oy
Salorankatu 10
FIN-24240 SALO
Finland

DRAWING TITLE

Datasheet Mirella reflector

DRAWN BY
pl

DATE
25.11.2011

CHECKED BY

DATE

SIZE
A4

DRAWING NUMBER

REV
1

DESIGNED BY
pl

DATE
25.11.2011

SCALE 1:1 WEIGHT (g)

SHEET 1/1

D

A

1

1

Luminaire: Ledil Oy CN12483_MIRELLA-50-S-DL_(Soleriq_S9)_SIMULATED
Lamps: 1 x Osram Soleriq S9 (GW KAJFB3.EM)

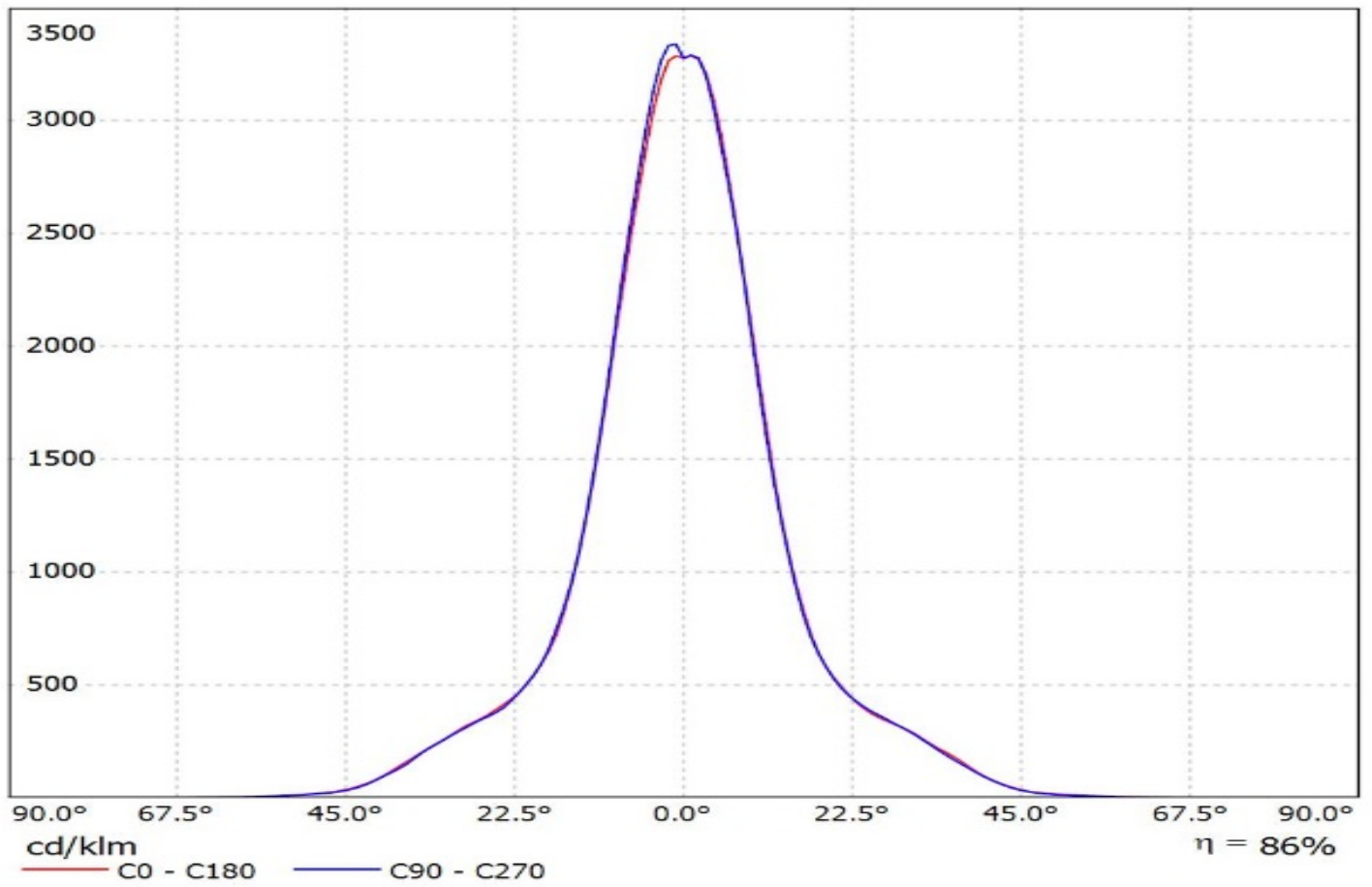

Luminaire: LEDiL Oy CN12483_MIRELLA-50-S-DL_(CREE_XHP50_WARM_WHITE)
Lamps: 1 x CREE_XHP50_WARM_WHITE_195.126lm@250mA_P=1.39922W_I=0.2499A

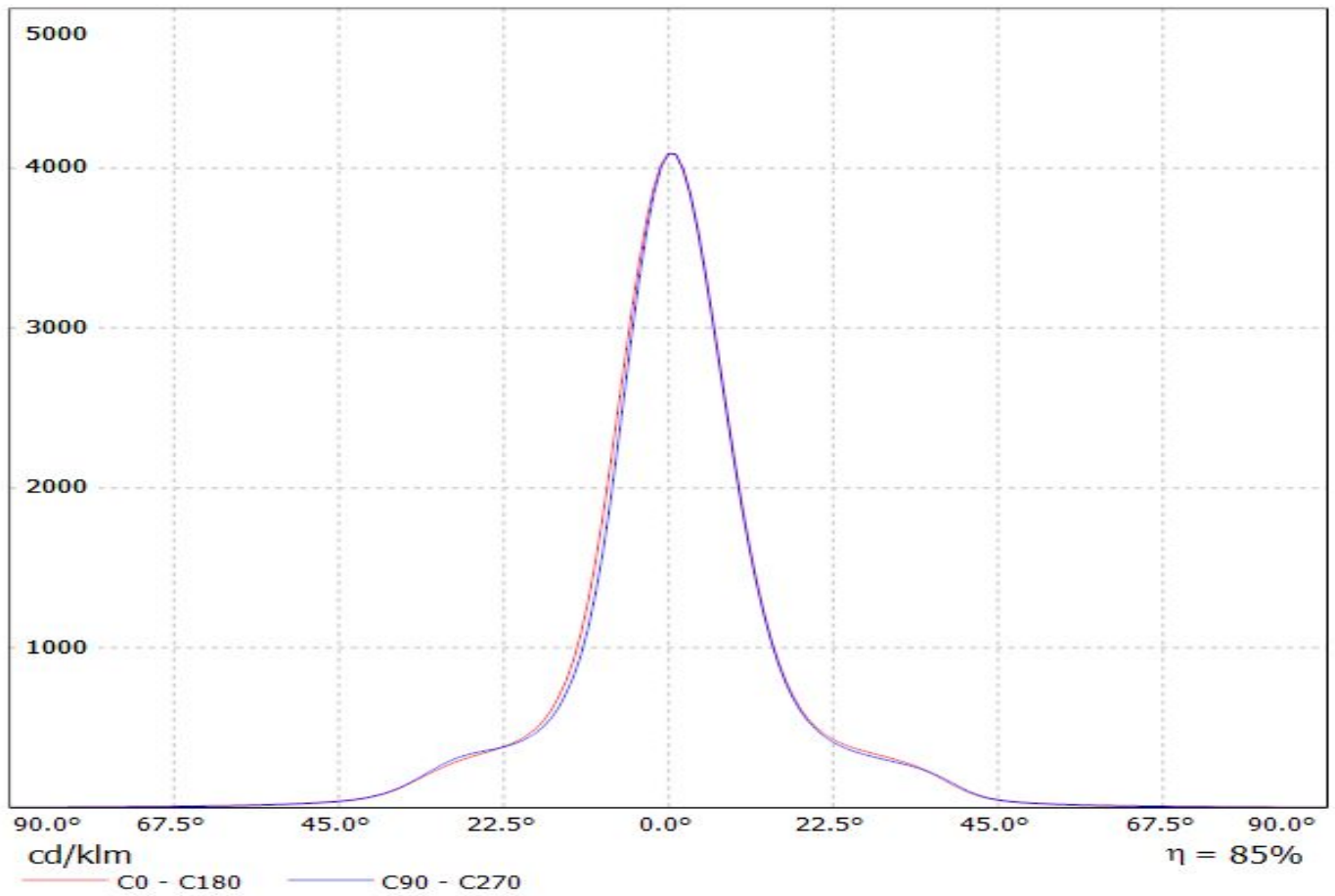

Luminaire: Ledil Oy CN12483_MIRELLA-50-S-DL (Bridgelux LS 170lm @ 250mA) Efficiency=83%
Lamps: 1 x Bridgelux LS 170lm @ 250mA

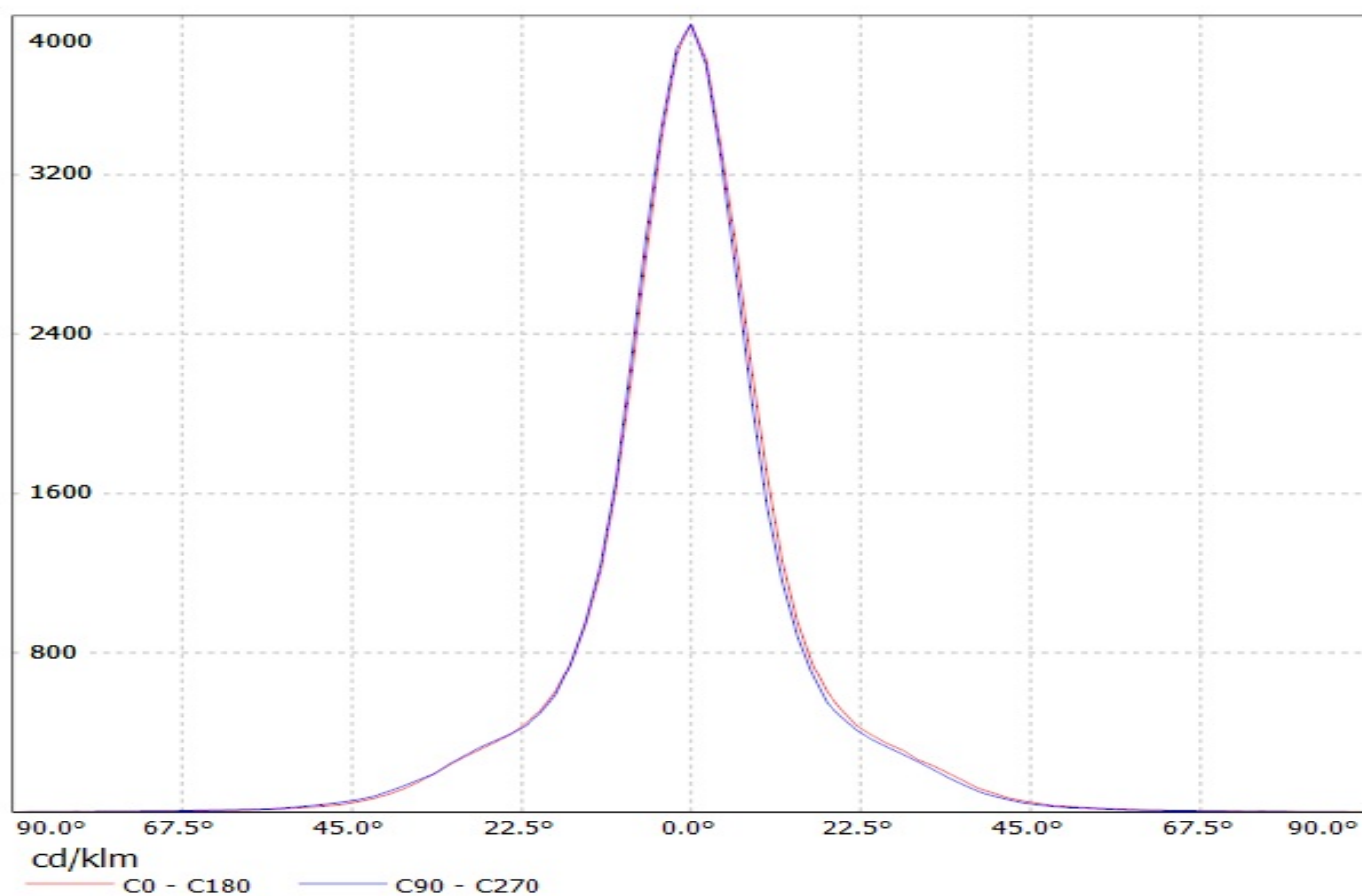

Luminaire: Ledil Oy CN12483_MIRELLA-50-S-DL (Nichia NSCxL036A 434lm @ 100mA) Efficiency=84%
Lamps: 1 x Nichia NSCxL036A 434lm @ 100mA (NSCLL036A) CCT=3000K P=3,4W I=100mA

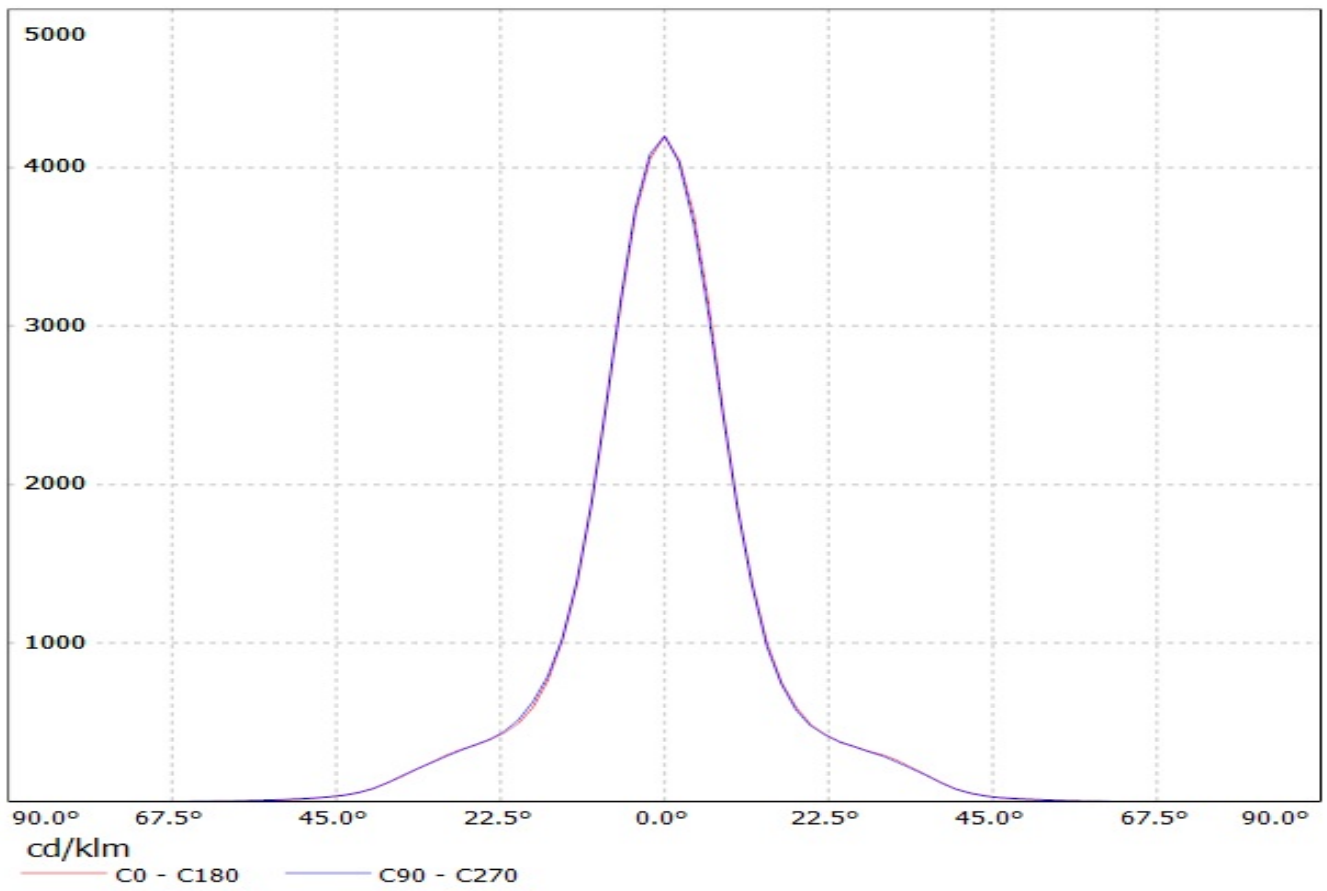

Luminaire: LEDiL Oy CN12483_MIRELLA-50-S-DL_(Cree_XHP70)
Lamps: 1 x Cree_XHP70_258.083lm@250mA_P=1.38117W_I=0.2499A

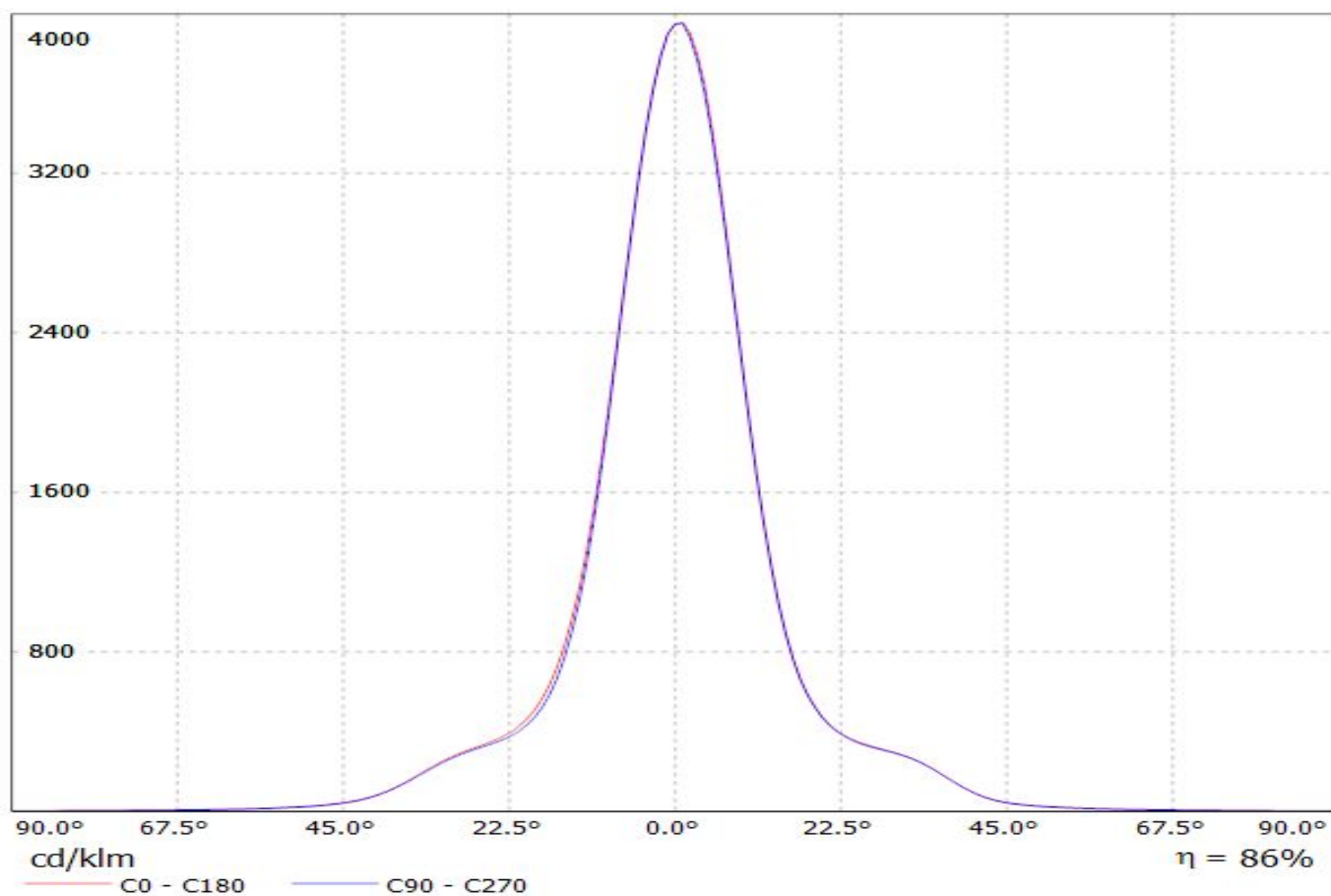

LEDiL Oy CN12483_MIRELLA-50-S-DL_(MT-G2) Eff.85.4% / LDC (Linear)

Luminaire: LEDiL Oy CN12483_MIRELLA-50-S-DL_(MT-G2) Eff.85.4%

Lamps: 1 x MT-G2 (171lm@250mA)

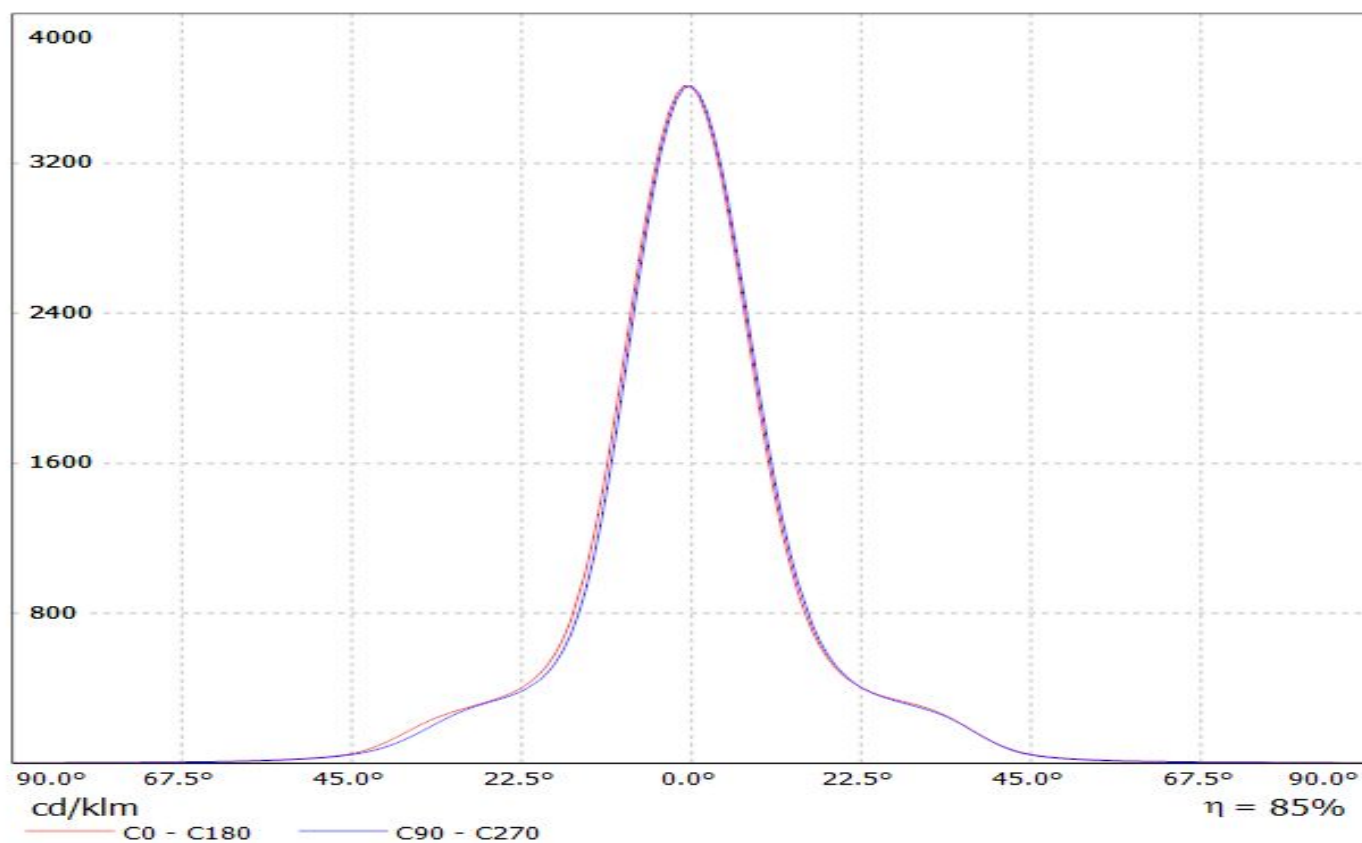

Luminaire: LEDIL OY C12478_MIRELLA-50-W_(MiniZenigata) Eff.88.9%
Lamps: 1 x Mini Zenigata (387.5lm@250mA)

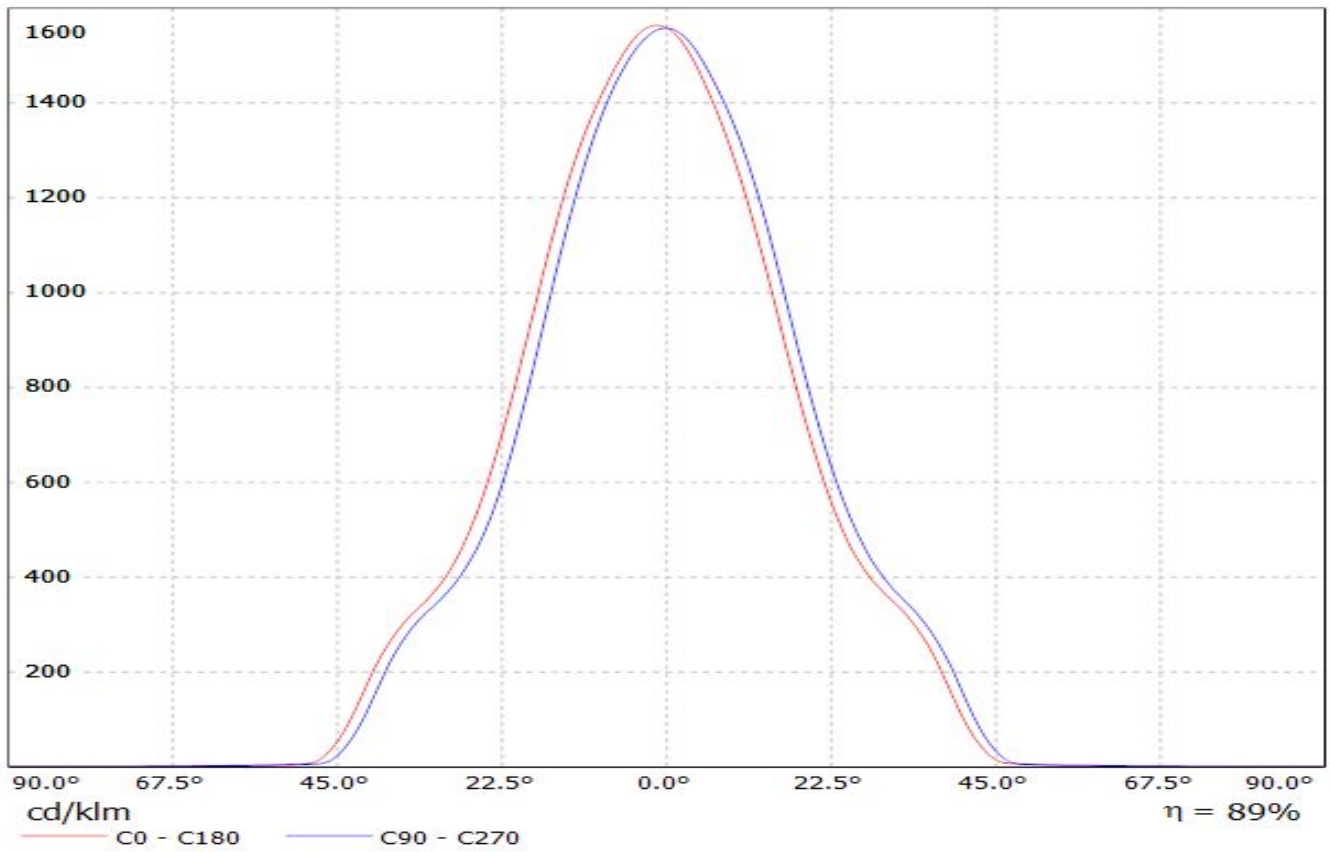

LEDiL Oy CN12483_MIRELLA-50-S-DL_(CXA1507) Eff.86.9% / LDC (Linear)

Luminaire: LEDiL Oy CN12483_MIRELLA-50-S-DL_(CXA1507) Eff.86.9%
Lamps: 1 x CREE_CXA1507 (CXA1507-30F-F2-N0A-00000) 238.378lm@50mA CCT=3000K P=1.8506W I=54.5mA

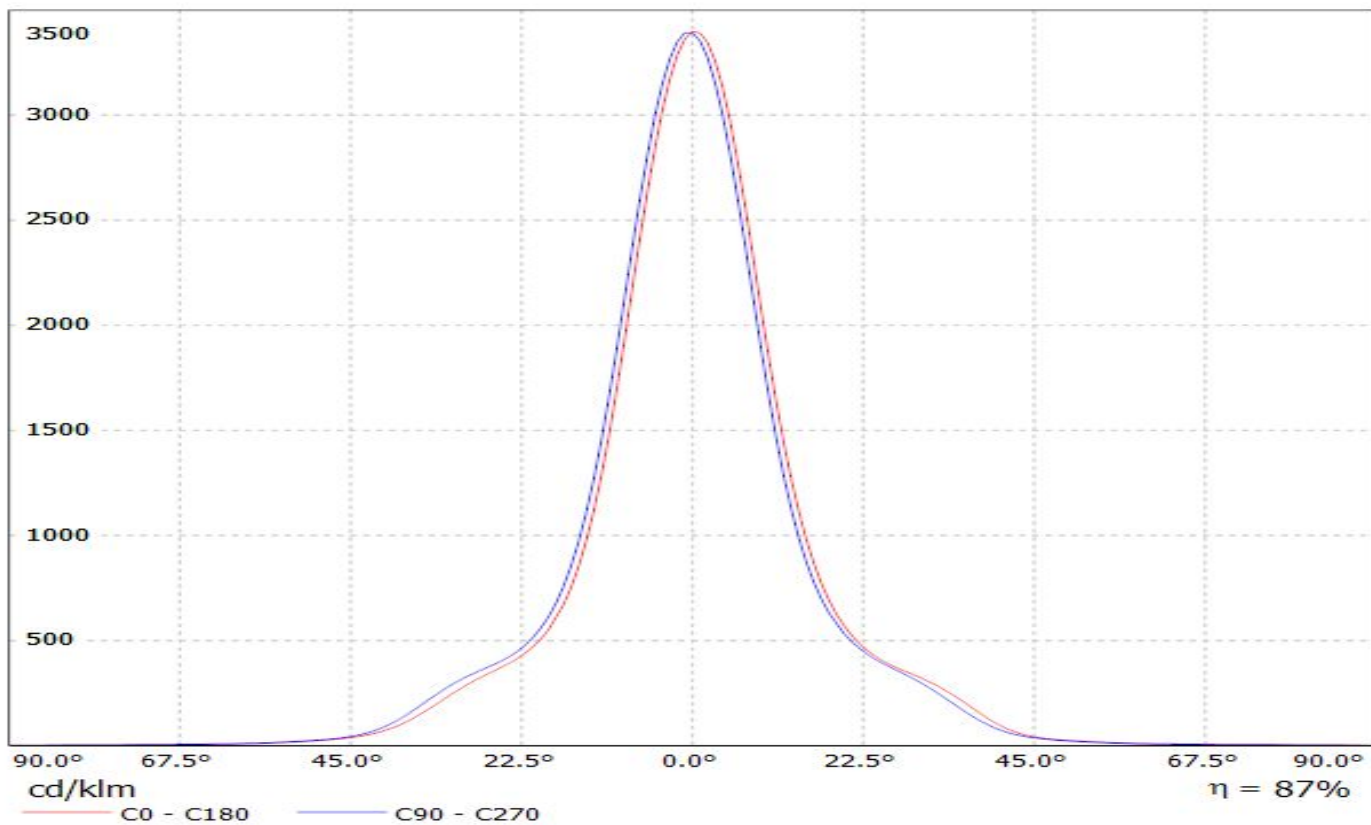

Luminaire: LEDiL Oy CN12483_MIRELLA-50-S-DL_(Mini_Zenigata) Eff.84.2%
Lamps: 1 x Mini_Zenigata GW6BM (803.772lm@250mA)

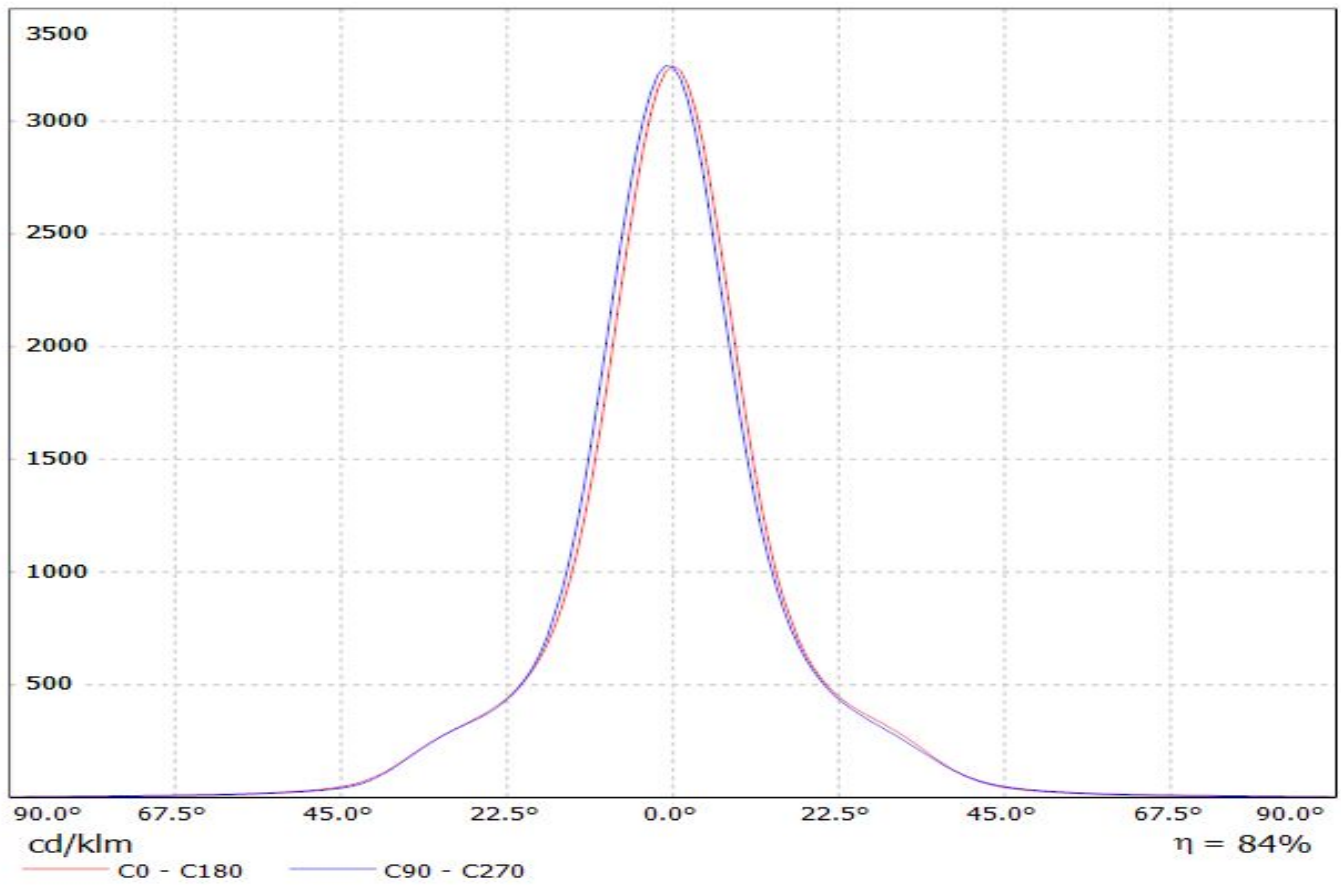

Luminaire: LEDil Oy CN12483_MIRELLA-50-S-DL_(Stark_SLE_G3_LES10) Efficiency=83%
Lamps: 1 x Tridonic Stark SLE G3 LES10 (STARK-SLE-PURE-G3-10-1000-830-CLA) 453lm @ 250mA CCT=3000K P=4.3W I=250mA

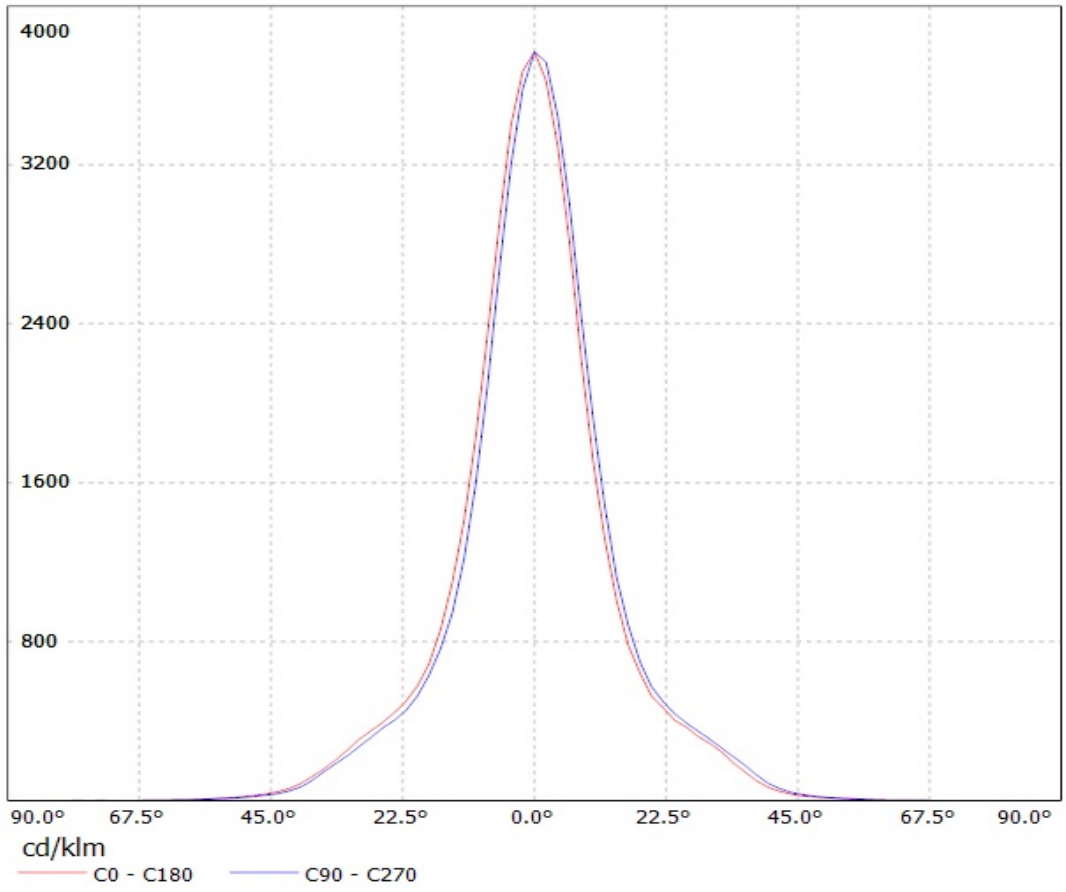

Luminaire: Ledil CN12483_MIRELLA-50-S-DL_(MHD-G)
Lamps: 1 x Cree MHD-G_528.649lm@100mA_P=3.0W_I=0.100A

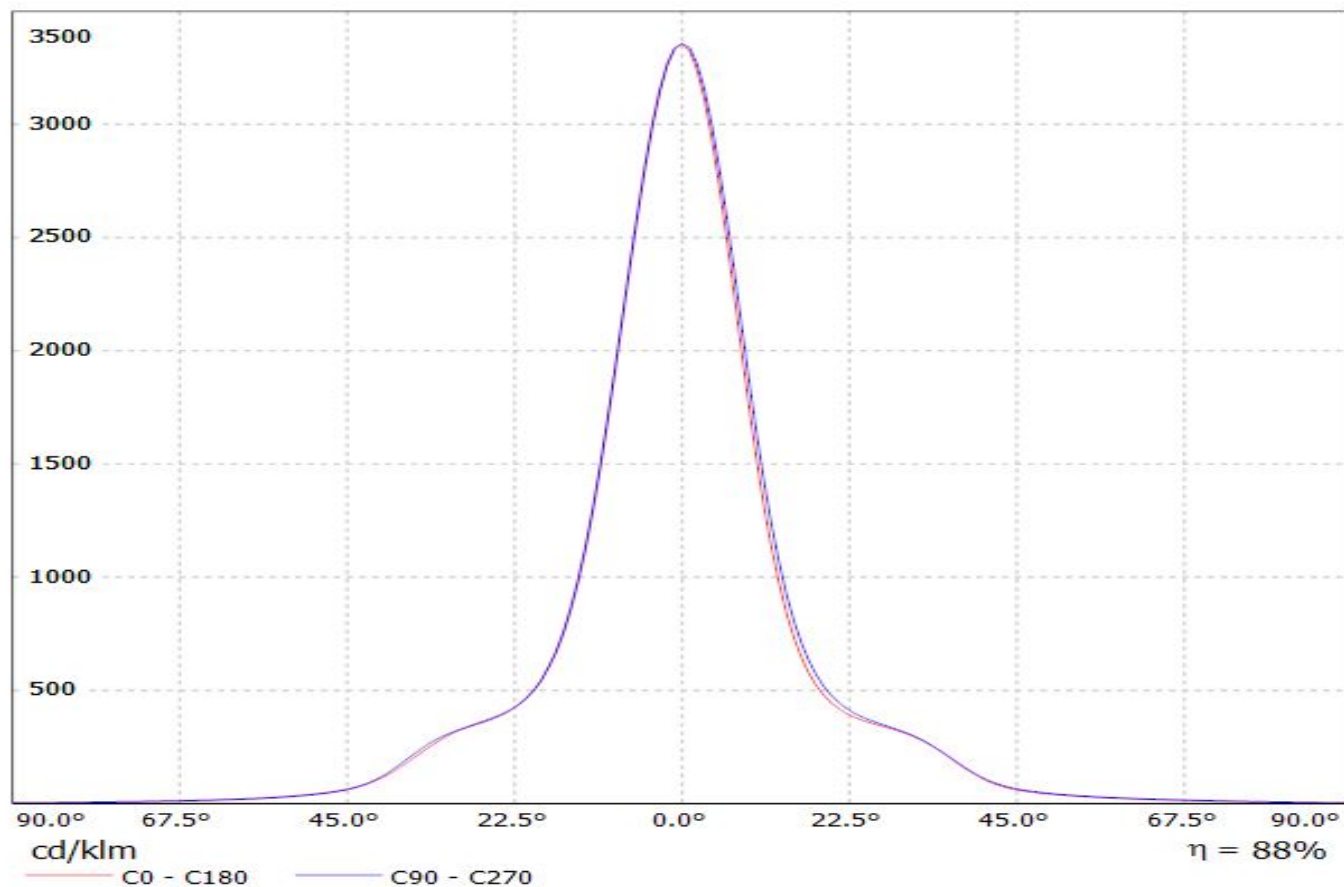

Luminaire: LEDil Oy CN12483_MIRELLA-50-S-DL_(ZC6) Efficiency=83%
Lamps: 1 x Seoul ZC6 (SDW81F1C) 422lm @ 100mA CCT=3100K P=3.4W I=100mA

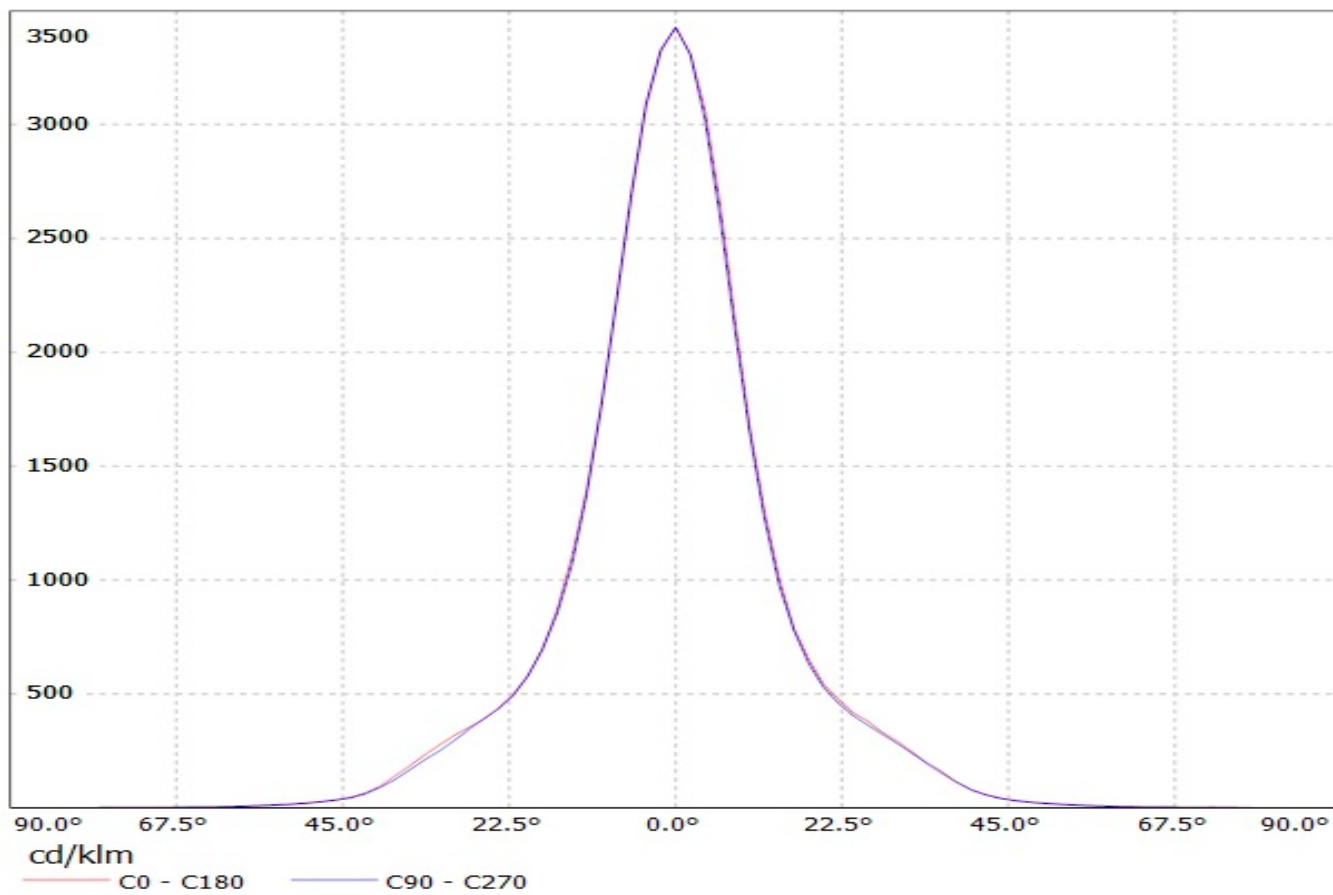

Luminaire: LEDiL Oy CN12483_MIRELLA-50-S-DL_(CLU700)

Lamps: 1 x CITIZEN_CLU700_(CLU700-100-2B8-273M2G1)_380.605lm@250mA_P=2.8002W_I=0.1001A

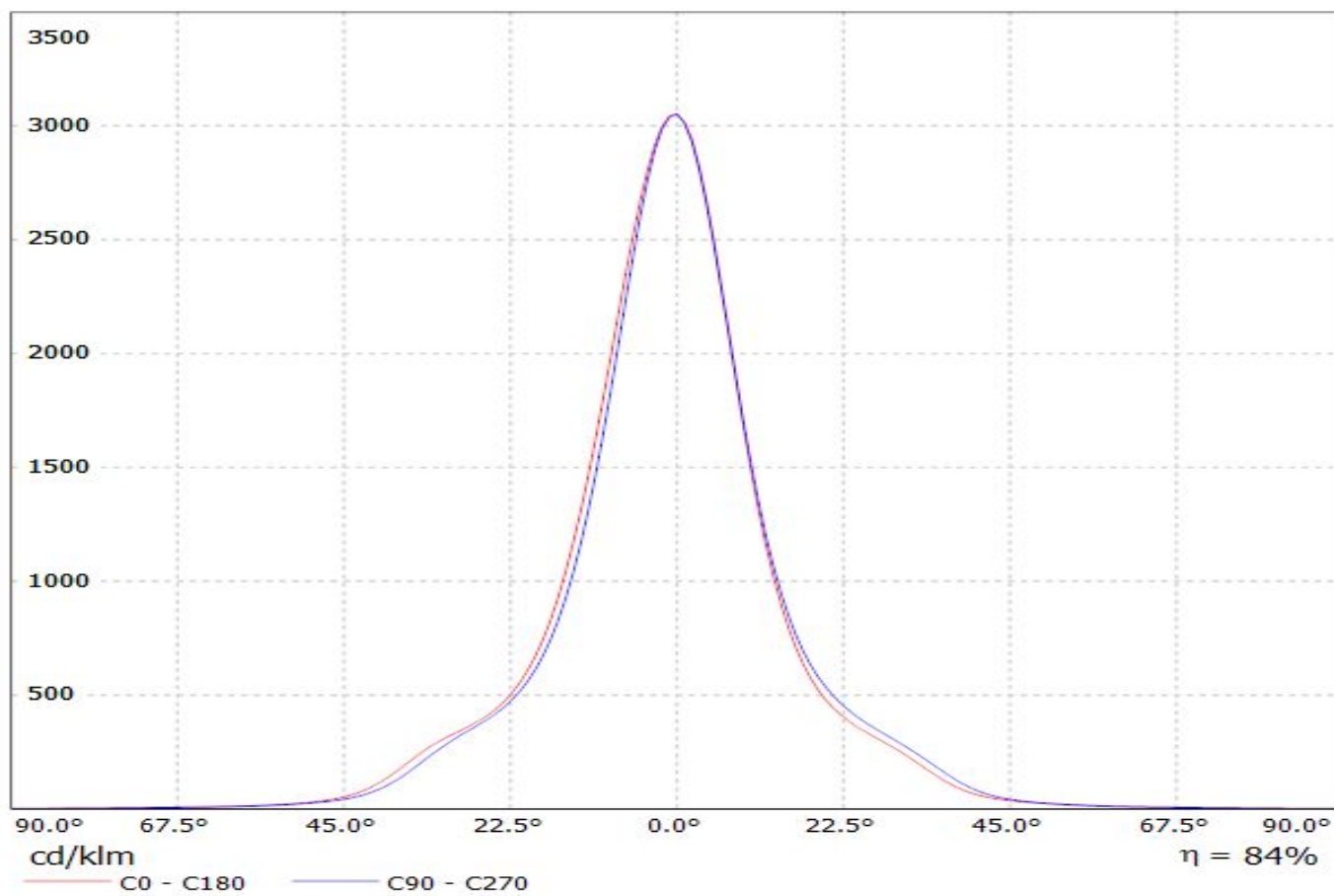

Luminaire: Ledil Oy CN12483_MIRELLA-50-S-DL (NSBxL066A 930lm @ 250mA) Efficiency=86%
Lamps: 1 x NSBxL066A 930lm @ 250mA (NSBLL066AE) CCT=3536K P=7,75W I=250mA

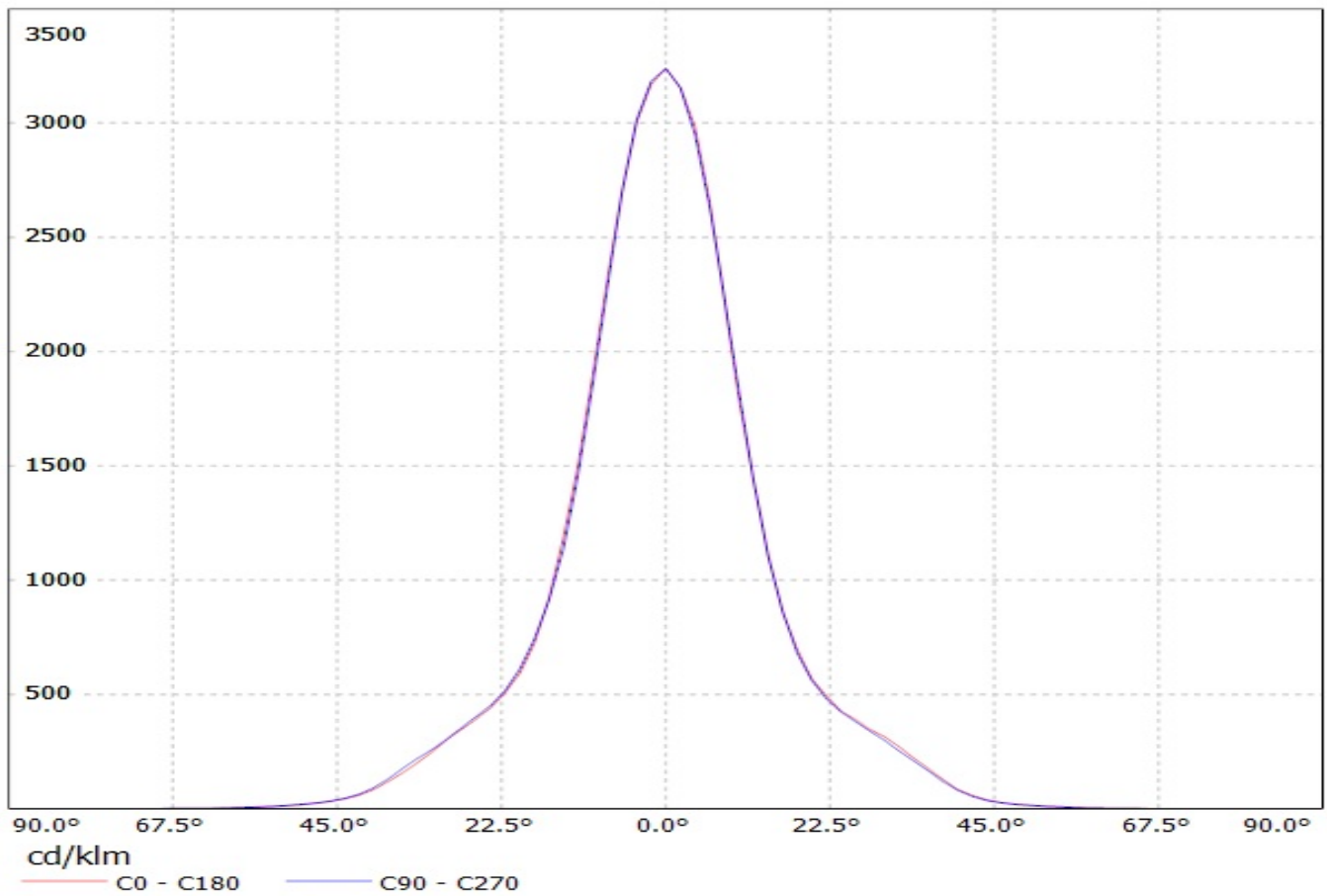

Luminaire: Ledil Oy CN12483_MIRELLA-50-S-DL_(Luxeon_CoB_1203) Efficiency= 85%
Lamps: 1 x Luxeon Cob 1203 (LHC1-3080-1203) 824lm @ 250mA CCT=3000K P=8.7W I= 250mA

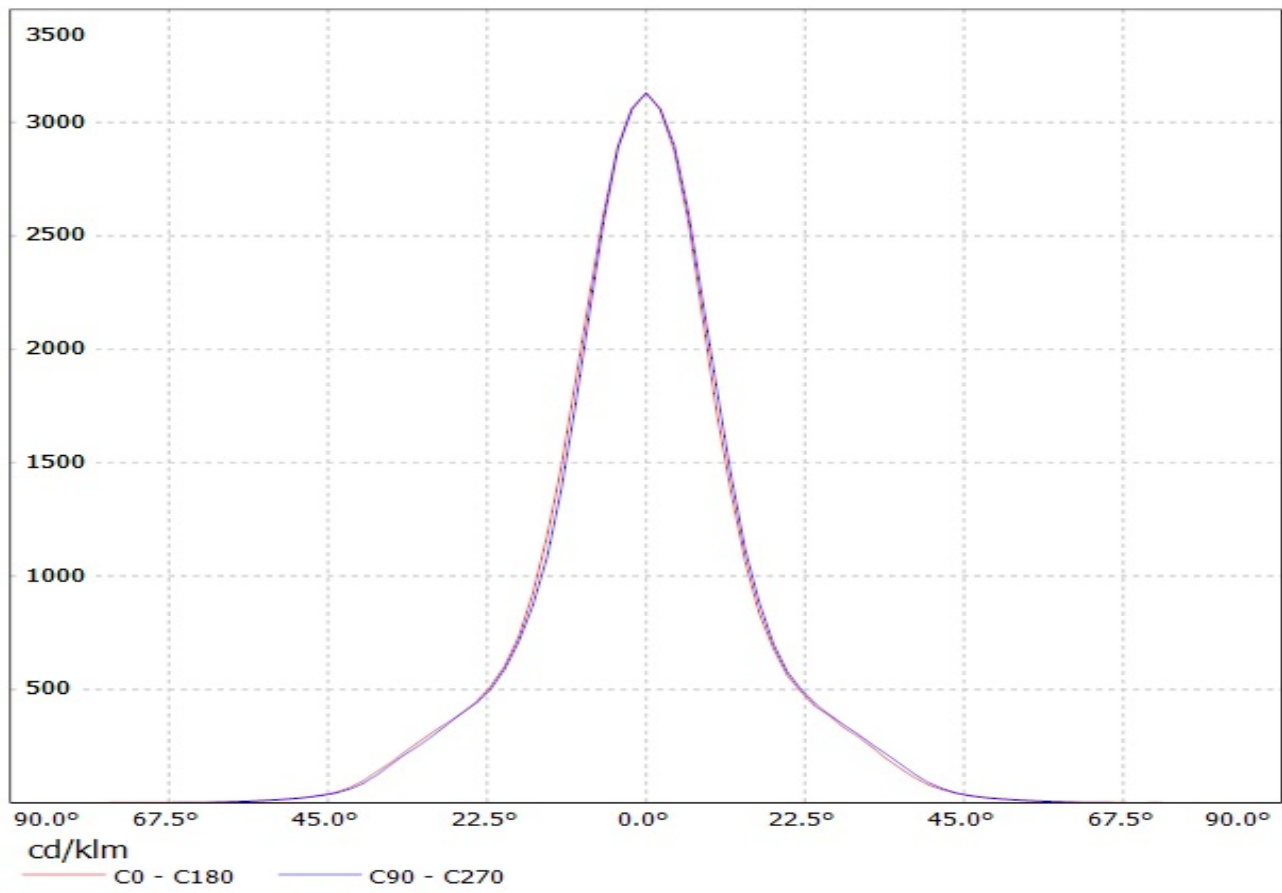

Luminaire: LEDiL Oy CN12483_MIRELLA-50-S-DL_(CXM-9)

Lamps: 1 x Luminus_XNOVA_CXM-9_(AA00)_974.083lm@240mA_P=8.27544W_I=240mA

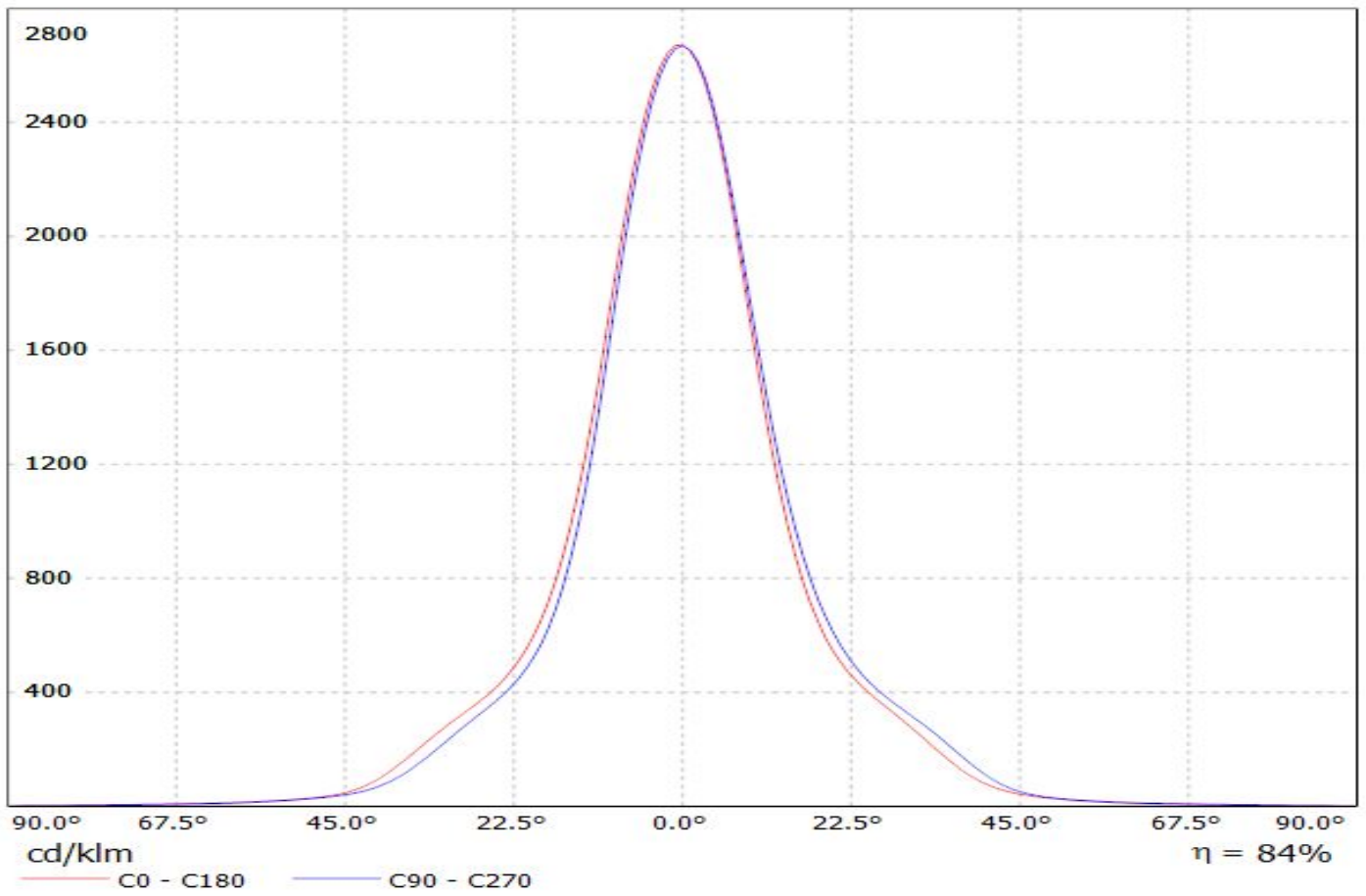

Luminaire: Ledil CN12483_MIRELLA-50-S-DL_(CLU710)

Lamps: 1 x CITIZEN_CLU710_(CLU710-1204B8-273M2G1)_1212.66lm@250mA_P=8.5W_I=0.25A

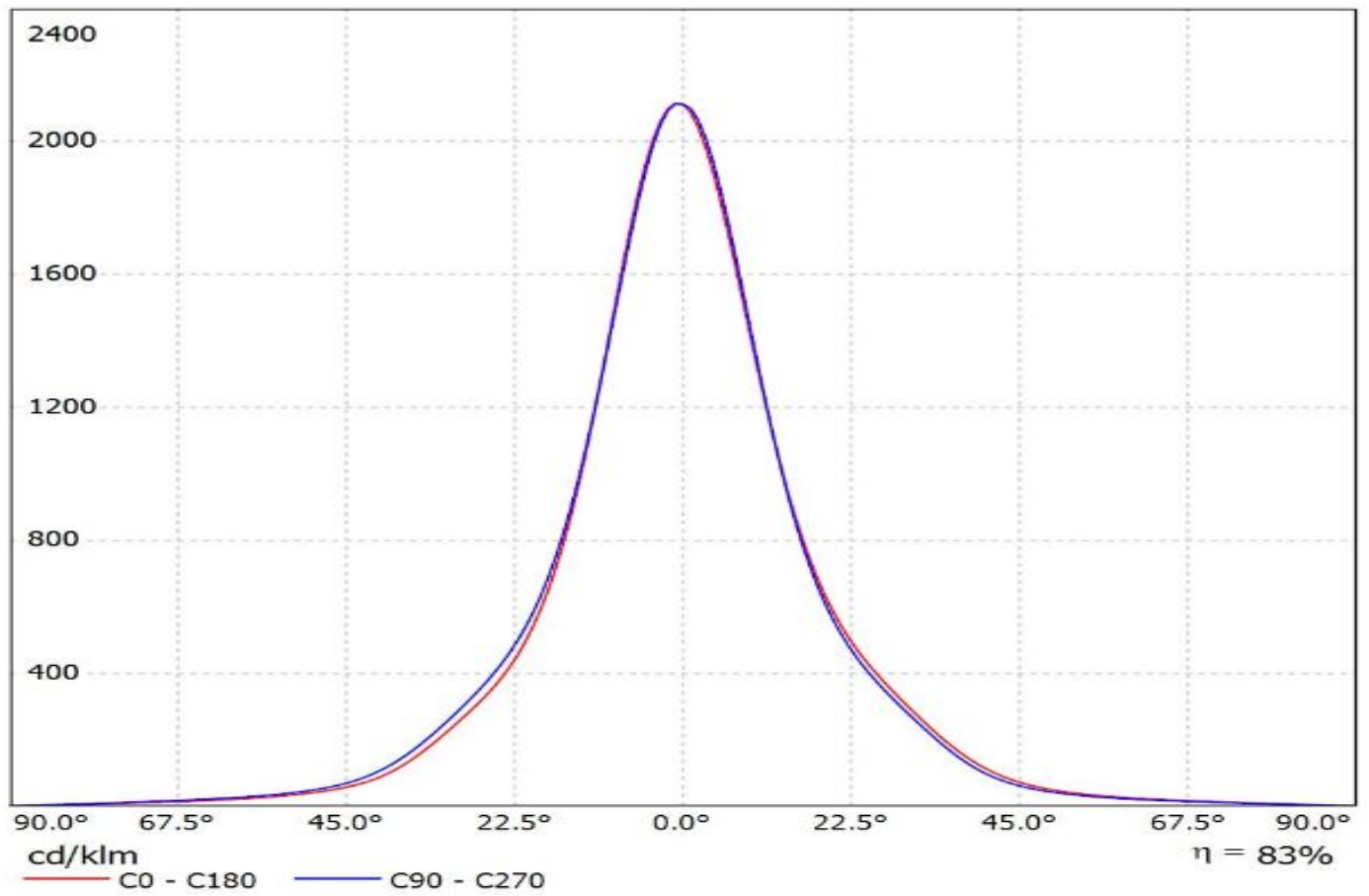

Luminaire: Ledil Oy
Lamps: 1 x CN12483_MIRELLA-50-S-DL_(CLL028)

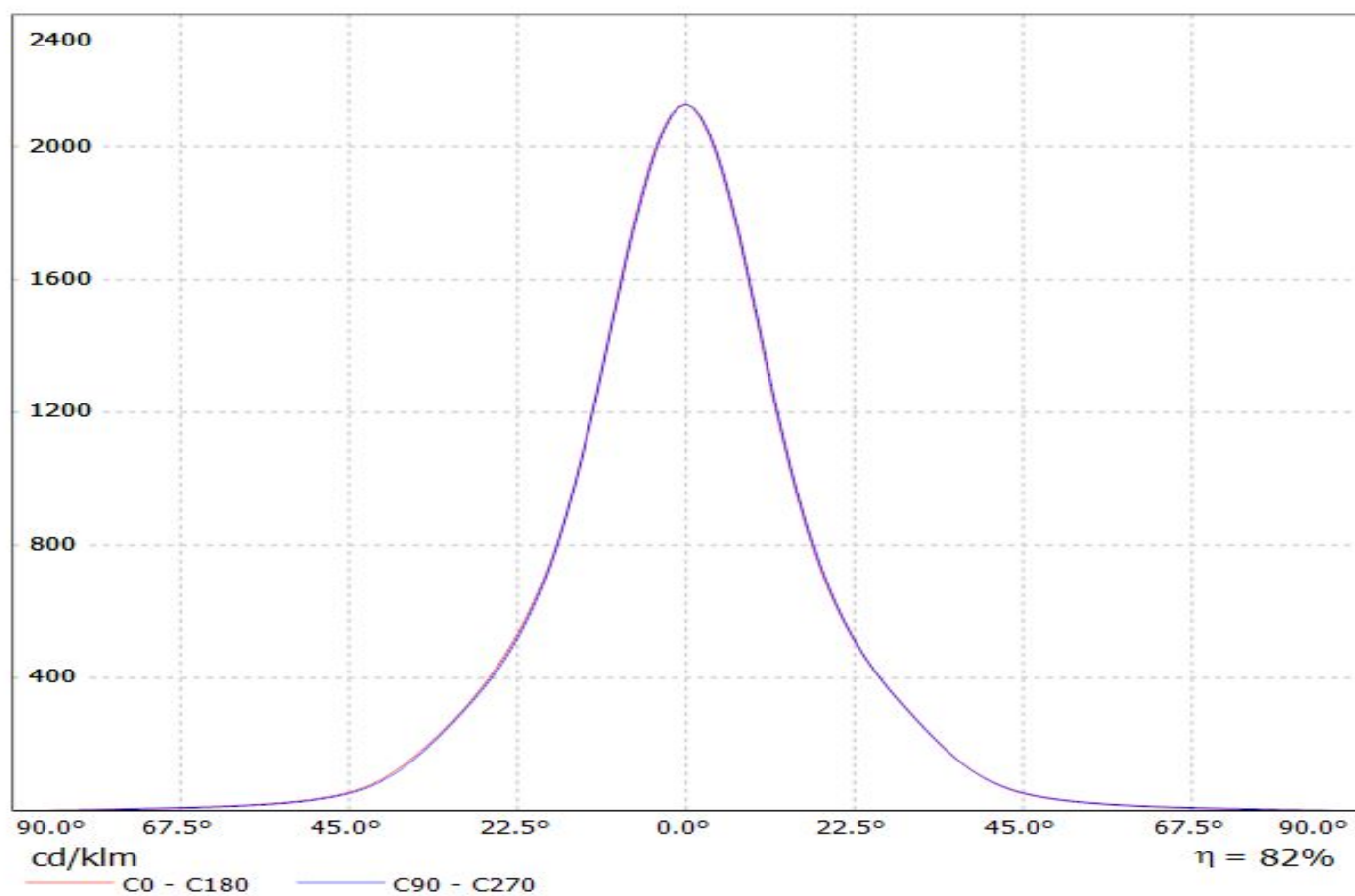

Luminaire: LEDil Oy CN12483_MIRELLA-50-S-DL_(Soleriq_S13) Efficiency=83%
Lamps: 1 x Osram Soleriq S13 (GW KAGHB1.EM) 832lm @ 250mA CCT=3100K P=7.4W I=250mA

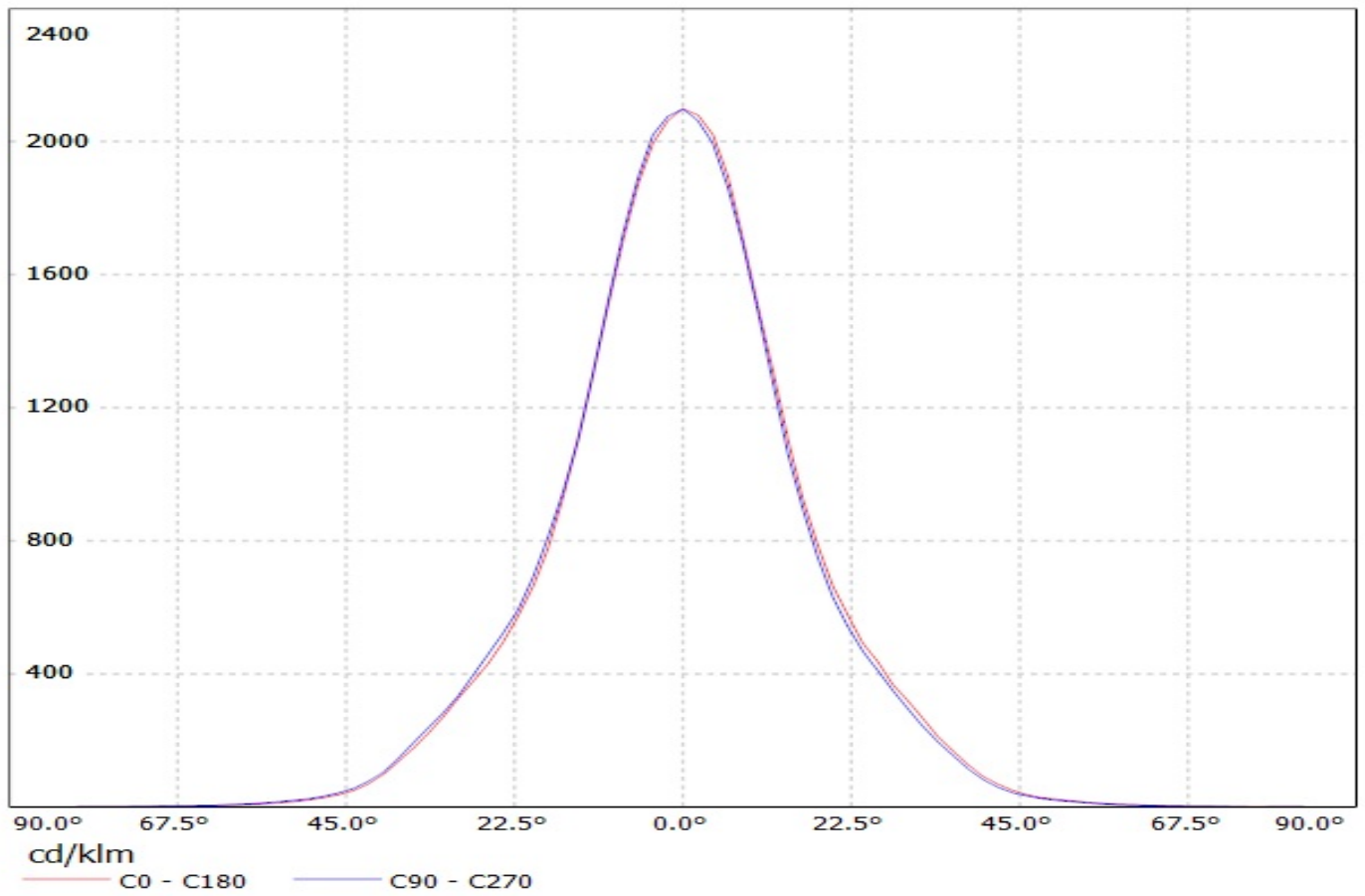

Luminaire: Ledil CN12483_MIRELLA-50-S-DL_(CLU720)
Lamps: 1 x CITIZEN_CLU720_(CLU720-1206B8-273M2)
_1298.17lm@250mA_CCT=2700K_P=8.3W_I=0.25A

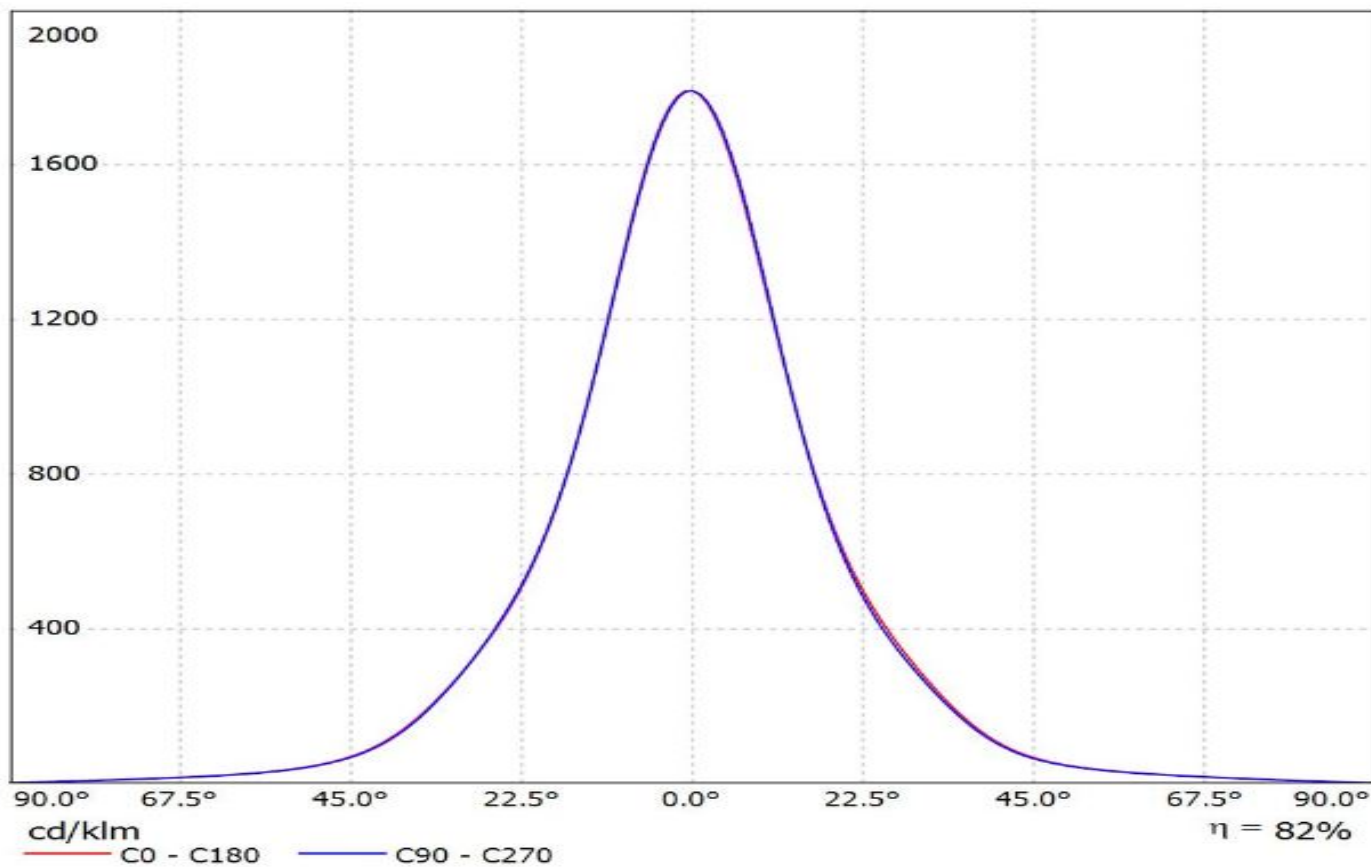

Luminaire: Ledil Oy CN12483_MIRELLA-50-S-DL_(Soleriq_S9)_SIMULATED
Lamps: 1 x Osram Soleriq S9 (GW KAJFB3.EM)

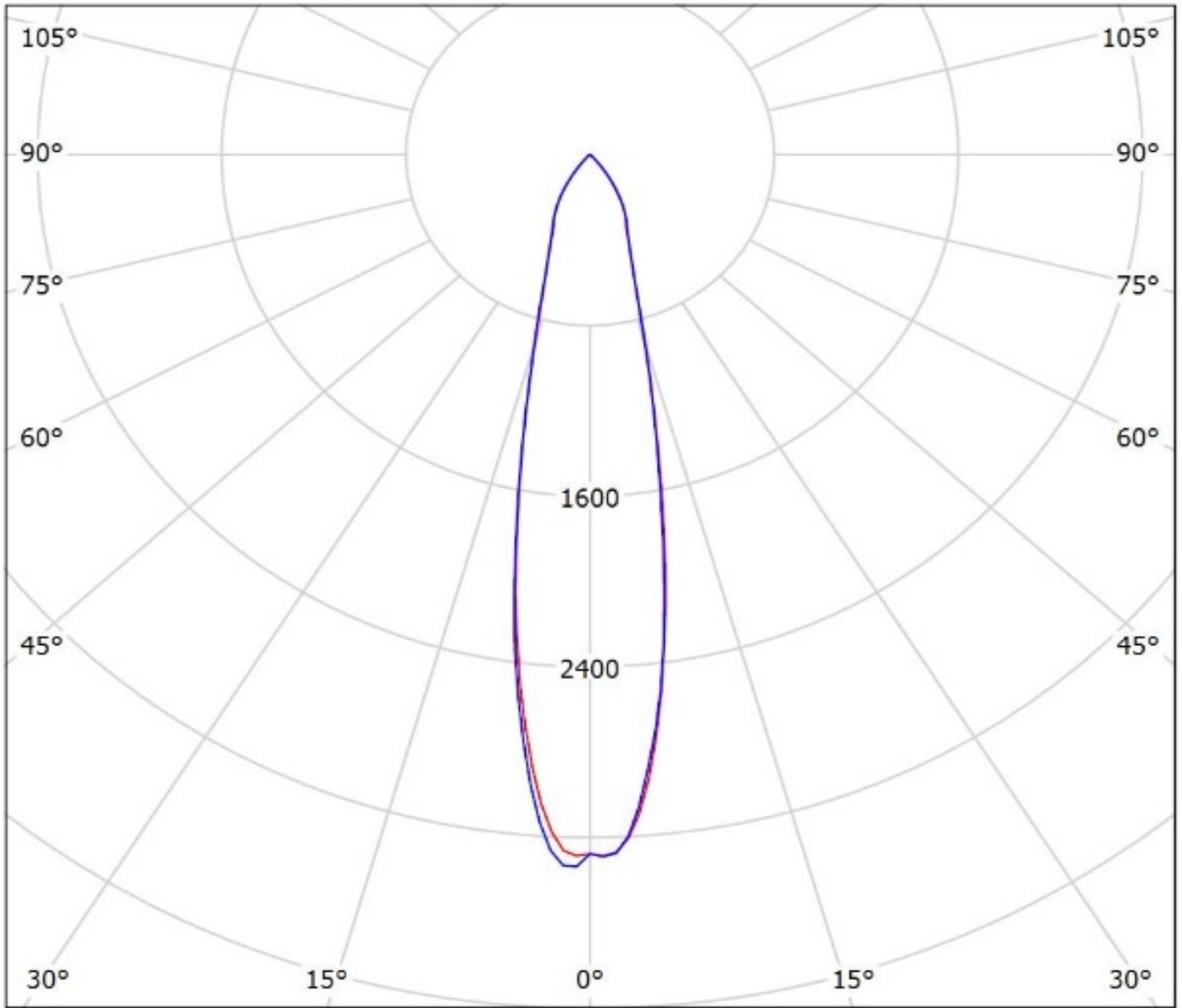

cd/klm
— C0 - C180 — C90 - C270

$\eta = 86\%$

Luminaire: LEDiL Oy CN12483_MIRELLA-50-S-DL_(CREE_XHP50_WARM_WHITE)
Lamps: 1 x CREE_XHP50_WARM_WHITE_195.126lm@250mA_P=1.39922W_I=0.2499A

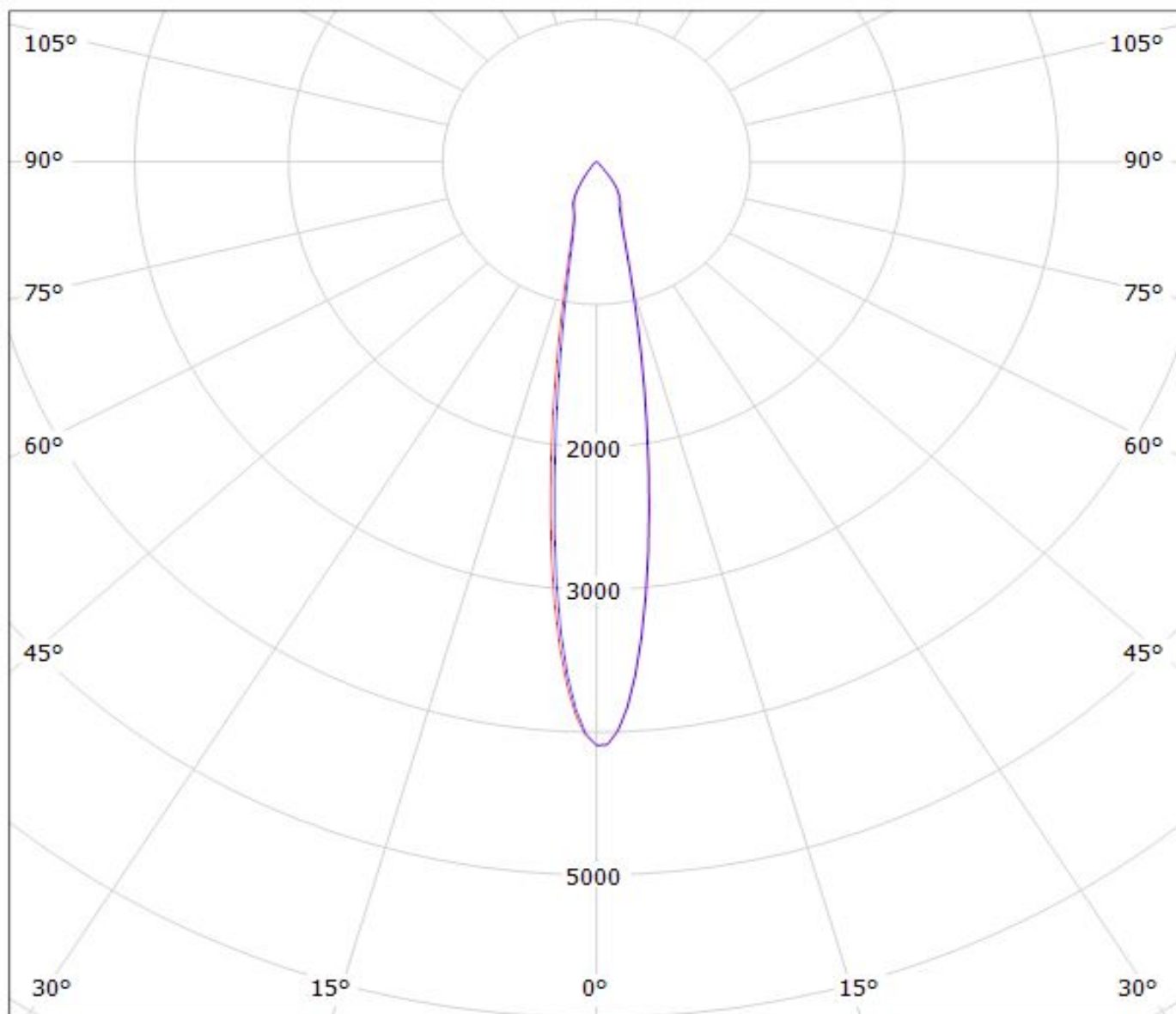

cd/klm

— C0 - C180 — C90 - C270

$\eta = 85\%$

Luminaire: Ledil Oy CN12483_MIRELLA-50-S-DL (Bridgelux LS 170lm @ 250mA) Efficiency=83%
Lamps: 1 x Bridgelux LS 170lm @ 250mA

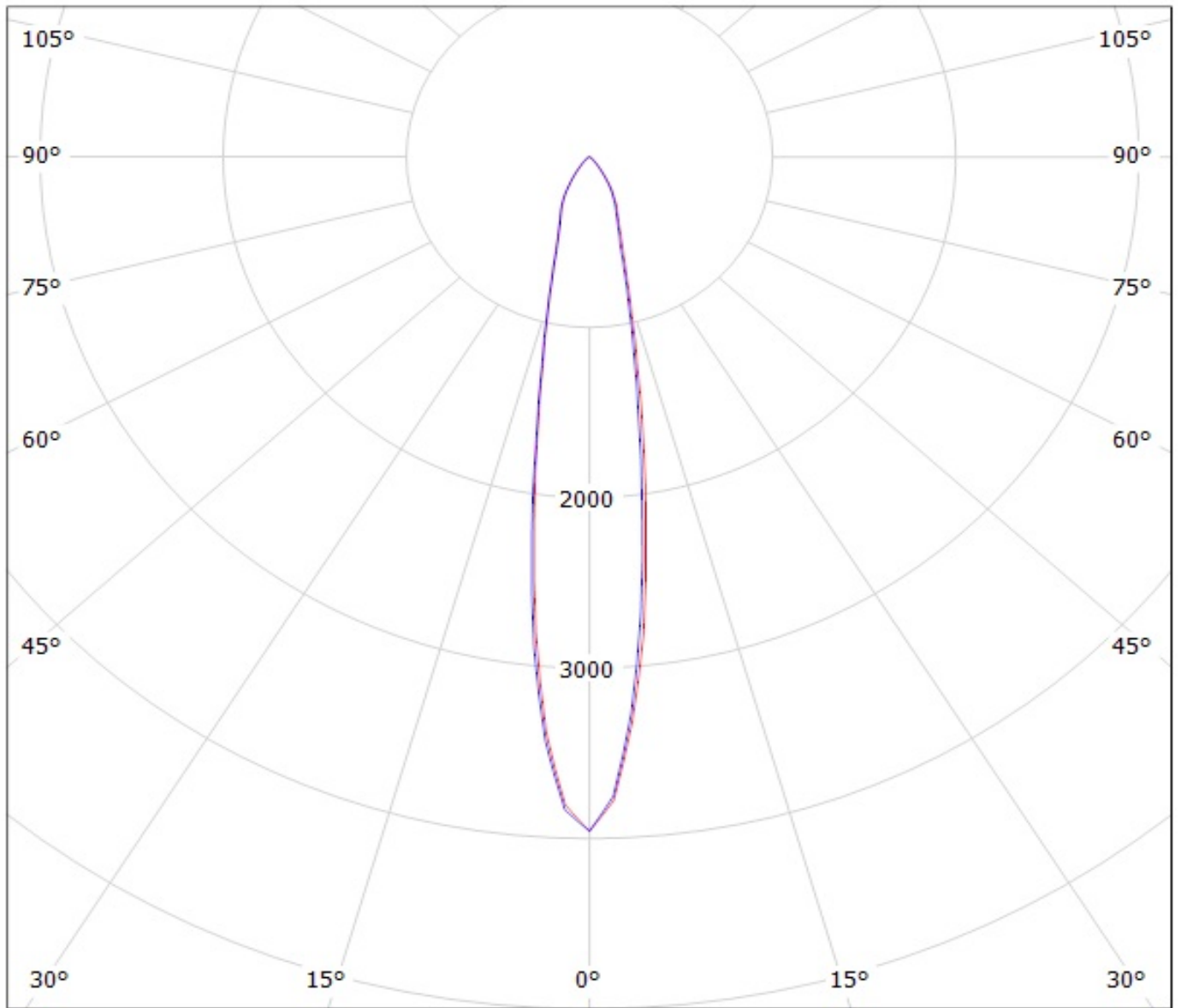

cd/klm

— C0 - C180

— C90 - C270

Luminaire: Ledil Oy CN12483_MIRELLA-50-S-DL (Nichia NSCxL036A 434lm @ 100mA) Efficiency=84%
Lamps: 1 x Nichia NSCxL036A 434lm @ 100mA (NSCLL036A) CCT=3000K P=3,4W I=100mA

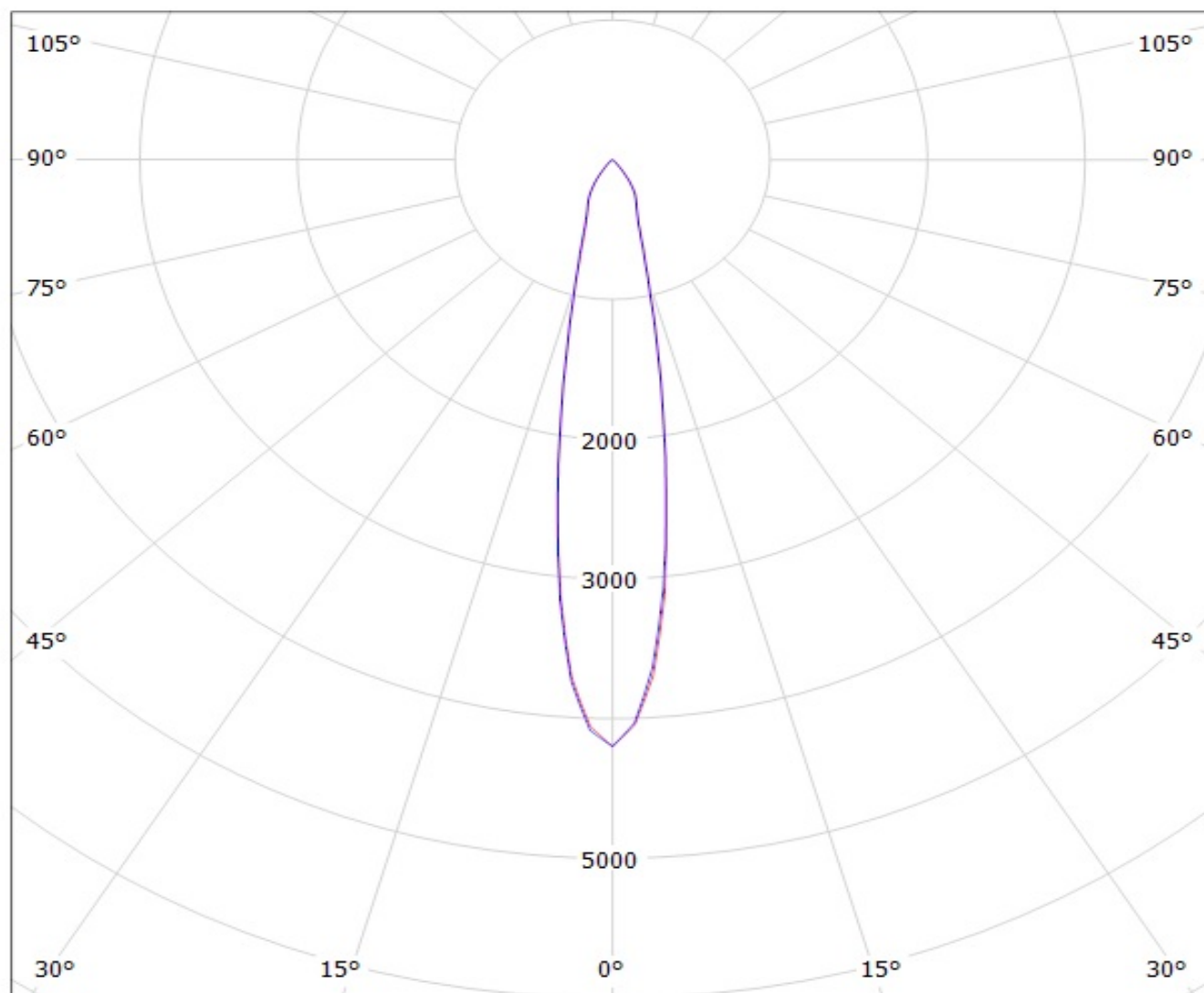

cd/klm

— C0 - C180

— C90 - C270

Luminaire: LEDiL Oy CN12483_MIRELLA-50-S-DL_(Cree_XHP70)
Lamps: 1 x Cree_XHP70_258.083lm@250mA_P=1.38117W_I=0.2499A

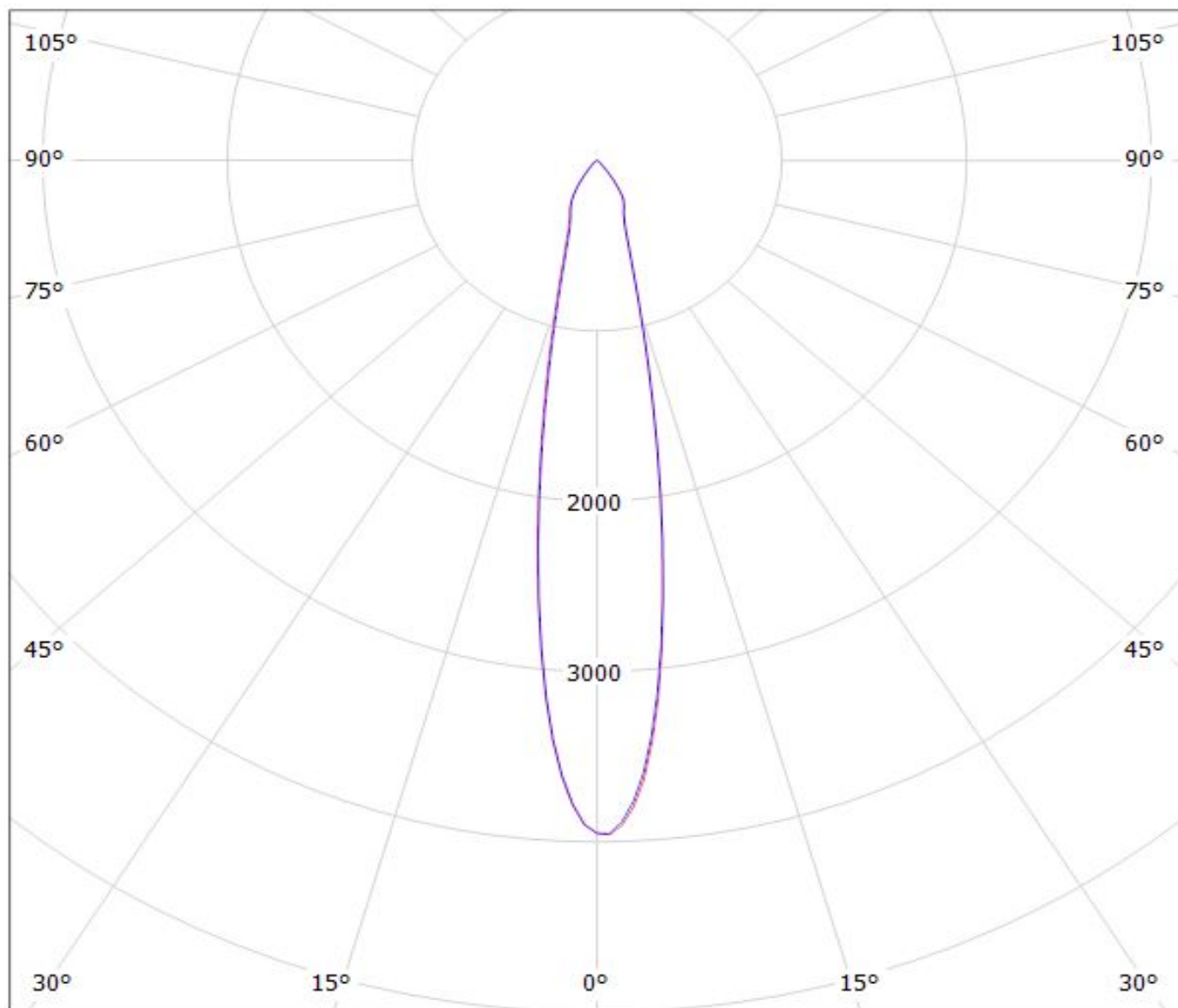

cd/klm

— C0 - C180 — C90 - C270

$\eta = 86\%$

LEDiL Oy CN12483_MIRELLA-50-S-DL_(MT-G2) Eff.85.4% / LDC (Polar)

Luminaire: LEDiL Oy CN12483_MIRELLA-50-S-DL_(MT-G2) Eff.85.4%

Lamps: 1 x MT-G2 (171lm@250mA)

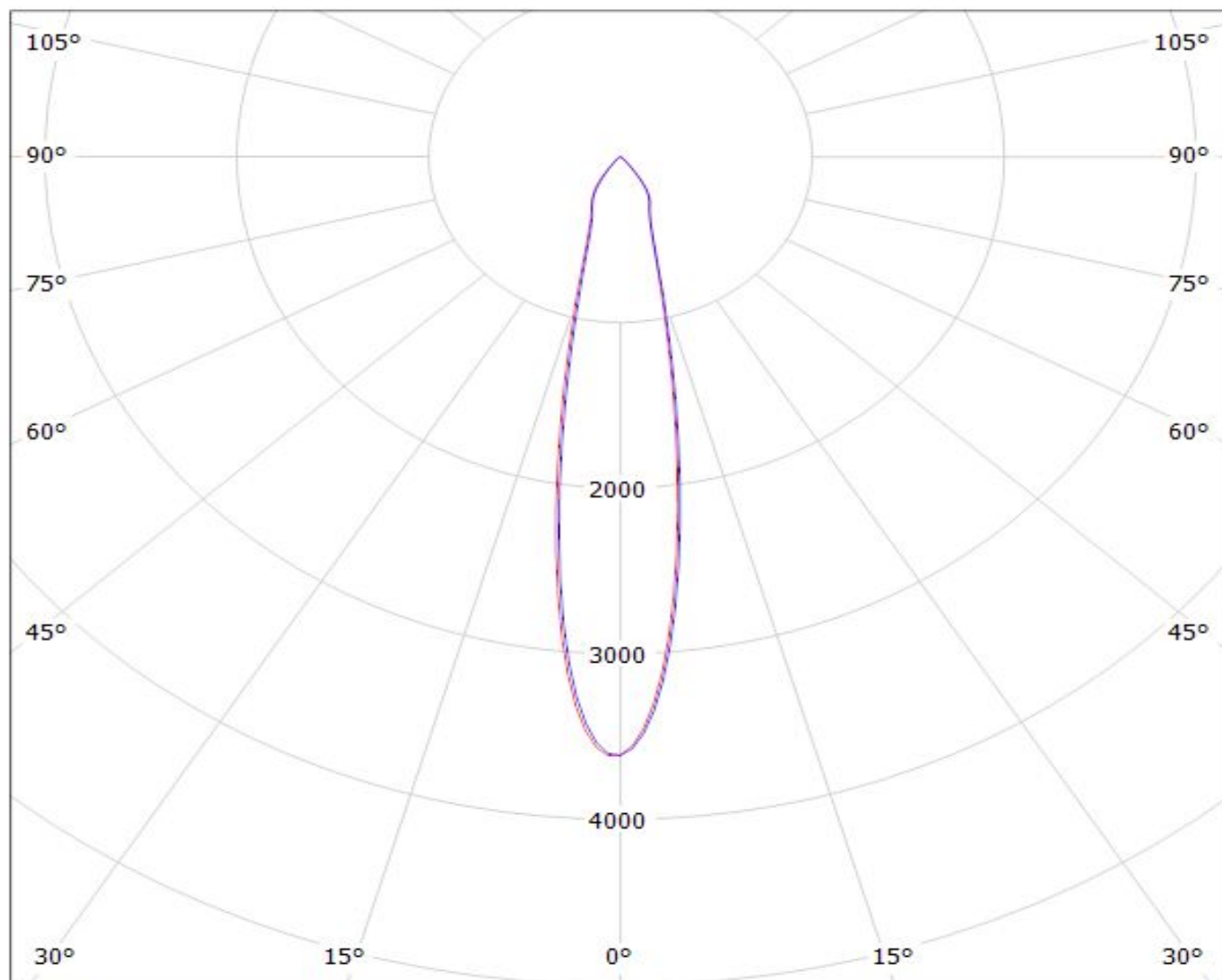

cd/klm

— C0 - C180

— C90 - C270

η = 85%

Luminaire: LEDIL OY CN12483_MIRELLA-50-S-DL_(MiniZenigata) Eff.86.1%
Lamps: 1 x Mini Zenigata (387.5lm@250mA)

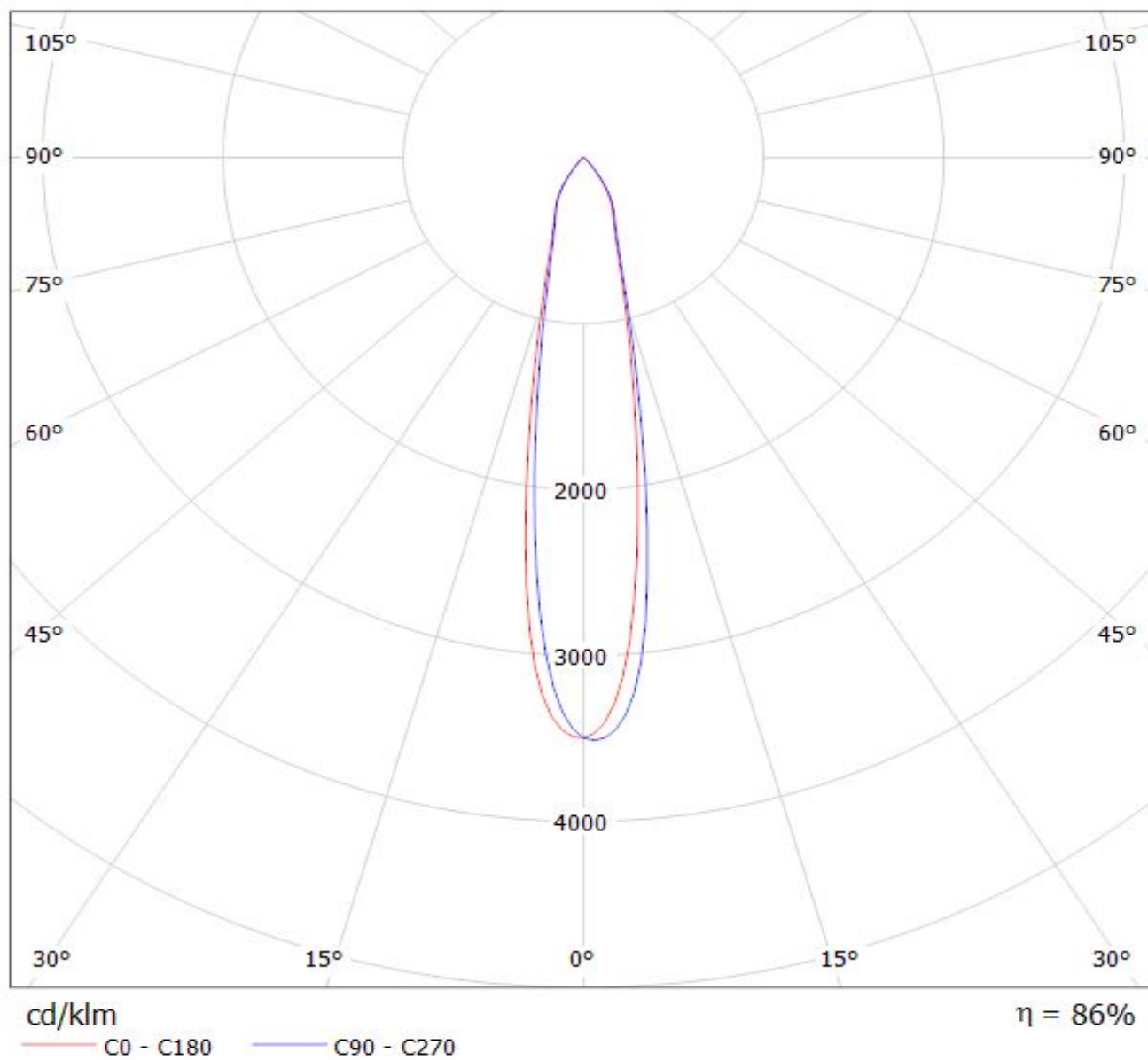

LEDiL Oy CN12483_MIRELLA-50-S-DL_(CXA1507) Eff.86.9% / LDC (Polar)

Luminaire: LEDiL Oy CN12483_MIRELLA-50-S-DL_(CXA1507) Eff.86.9%

Lamps: 1 x CREE_CXA1507 (CXA1507-30F-F2-N0A-00000) 238.378lm@50mA CCT=3000K P=1.8506W I=54.5mA

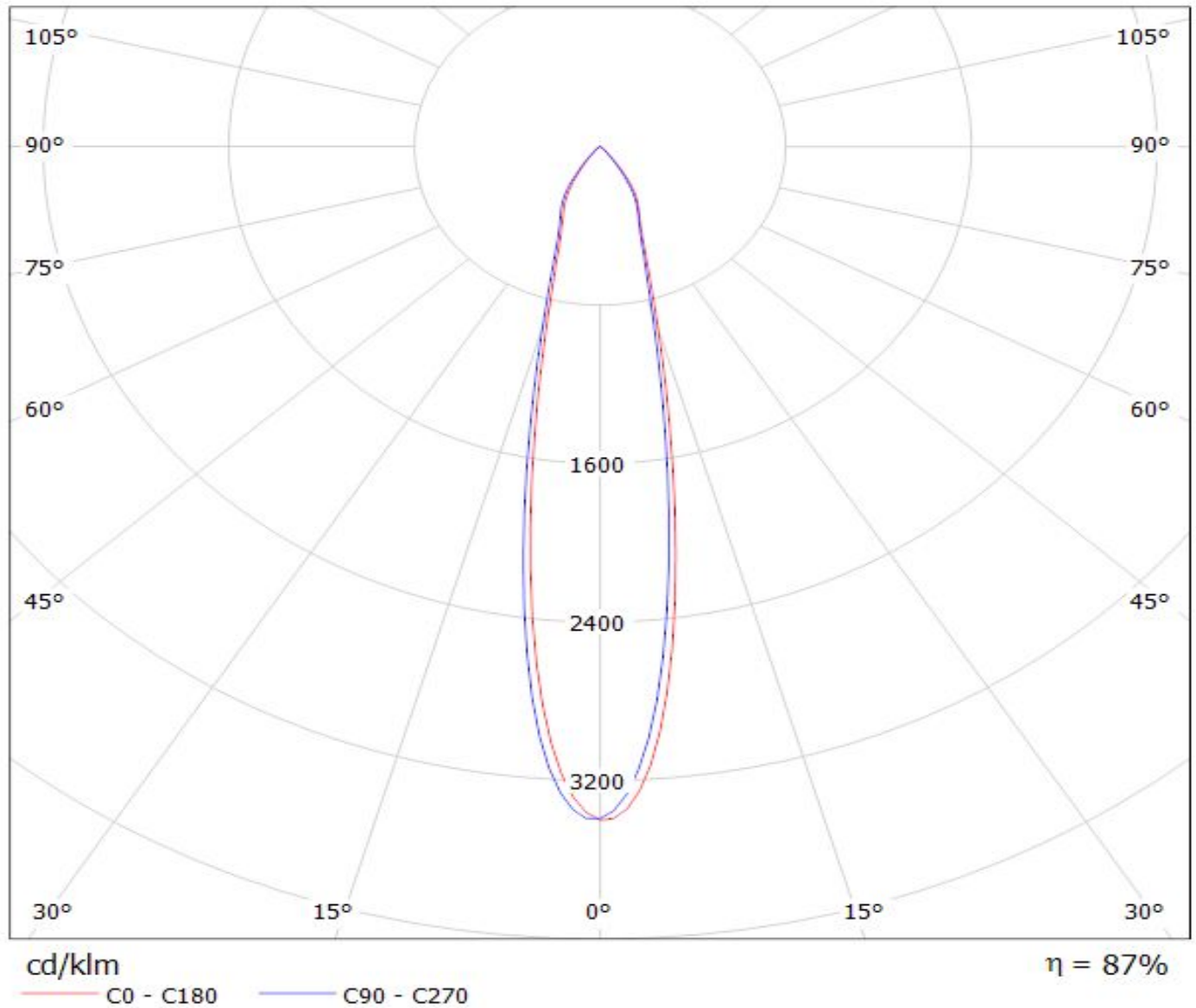

Luminaire: LEDiL Oy CN12483_MIRELLA-50-S-DL_(Mini_Zenigata) Eff.84.2%
Lamps: 1 x Mini_Zenigata GW6BM (803.772lm@250mA)

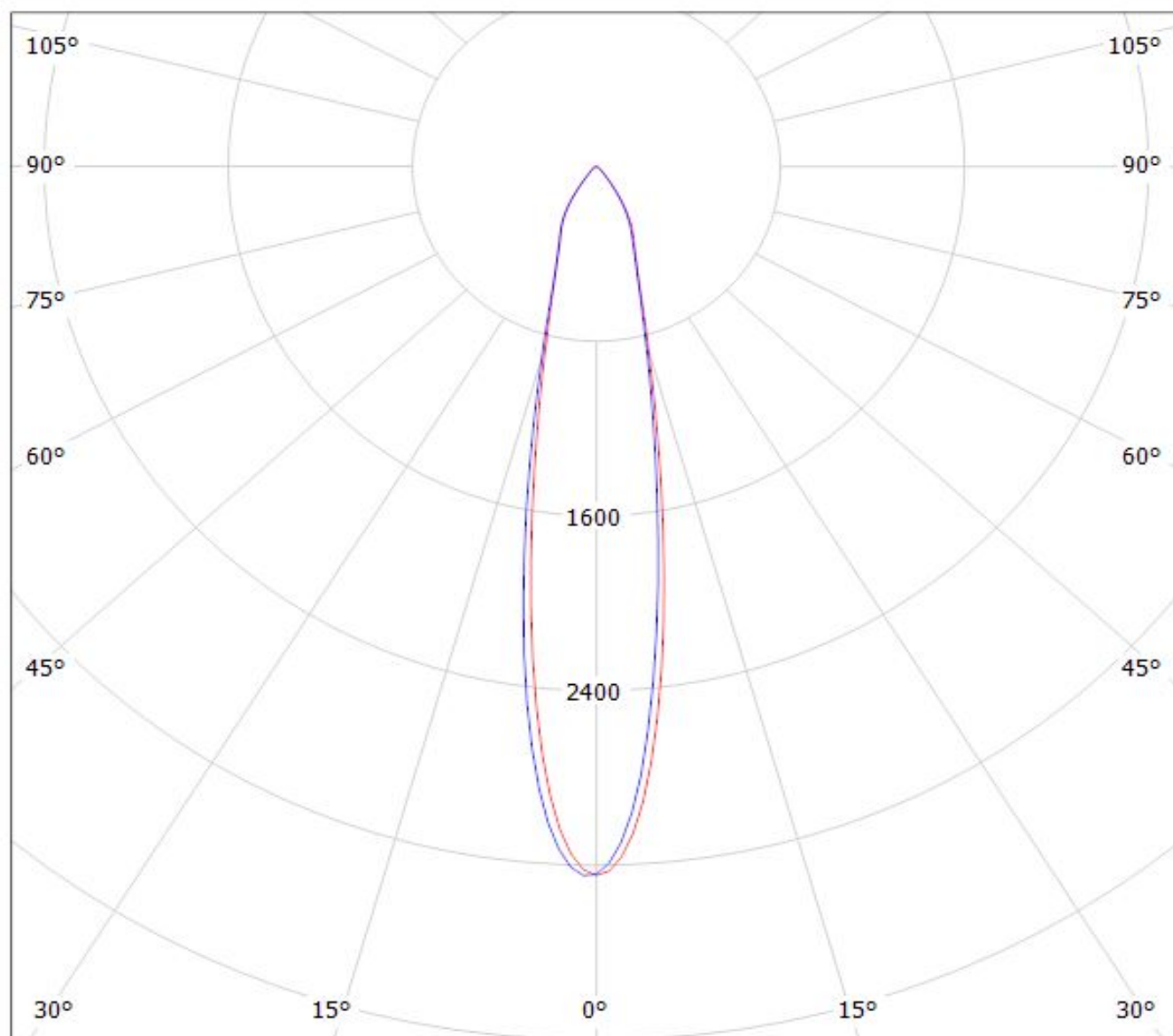

cd/klm

— C0 - C180 — C90 - C270

$\eta = 84\%$

Luminaire: LEDil Oy CN12483_MIRELLA-50-S-DL_(Stark_SLE_G3_LES10) Efficiency=83%

Lamps: 1 x Tridonic Stark SLE G3 LES10 (STARK-SLE-PURE-G3-10-1000-830-CLA) 453lm @ 250mA CCT=3000K P=4.3W I=250mA

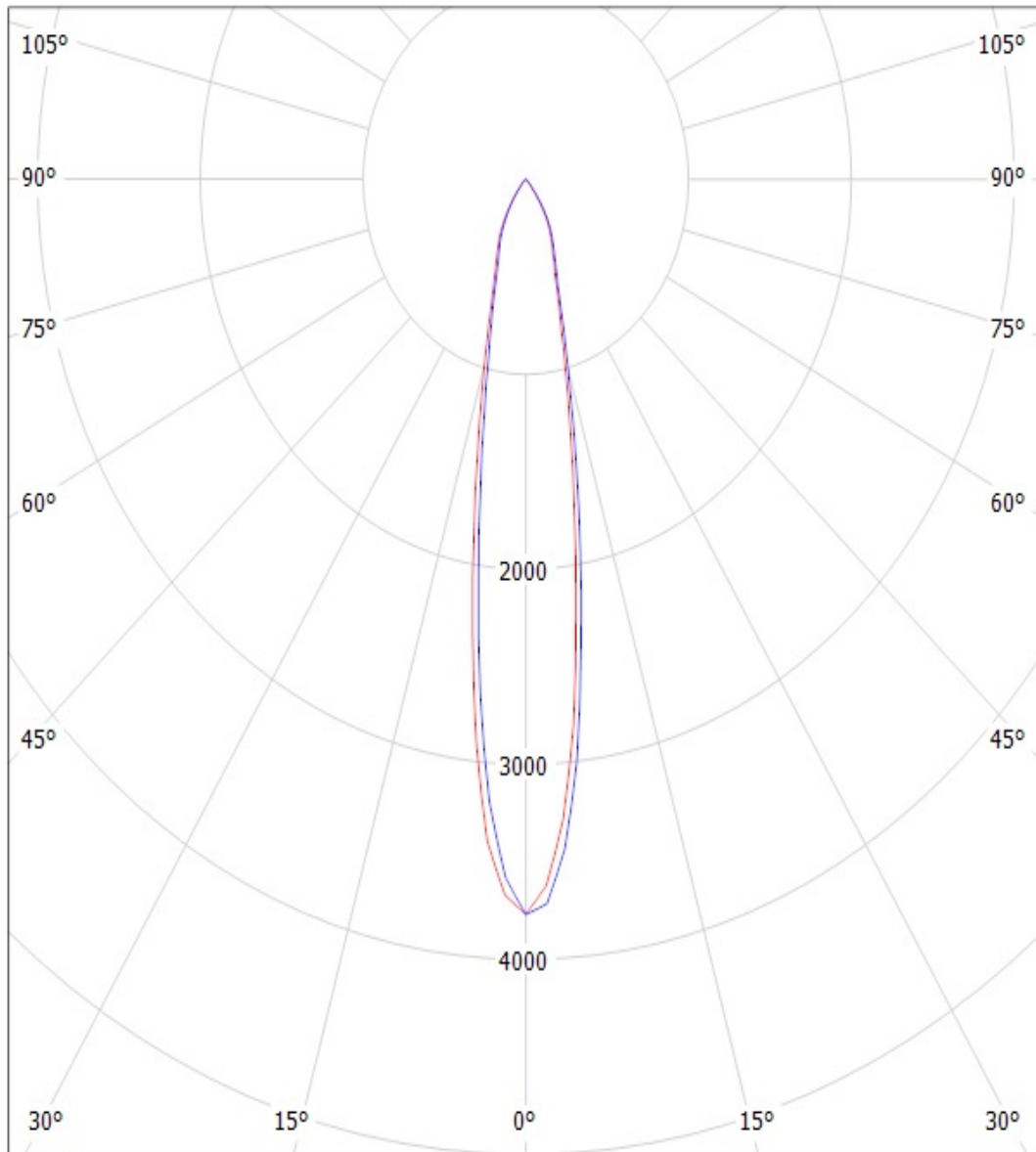

cd/klm

— C0 - C180 — C90 - C270

Luminaire: Ledil CN12483_MIRELLA-50-S-DL_(MHD-G)
Lamps: 1 x Cree MHD-G_528.649lm@100mA_P=3.0W_I=0.100A

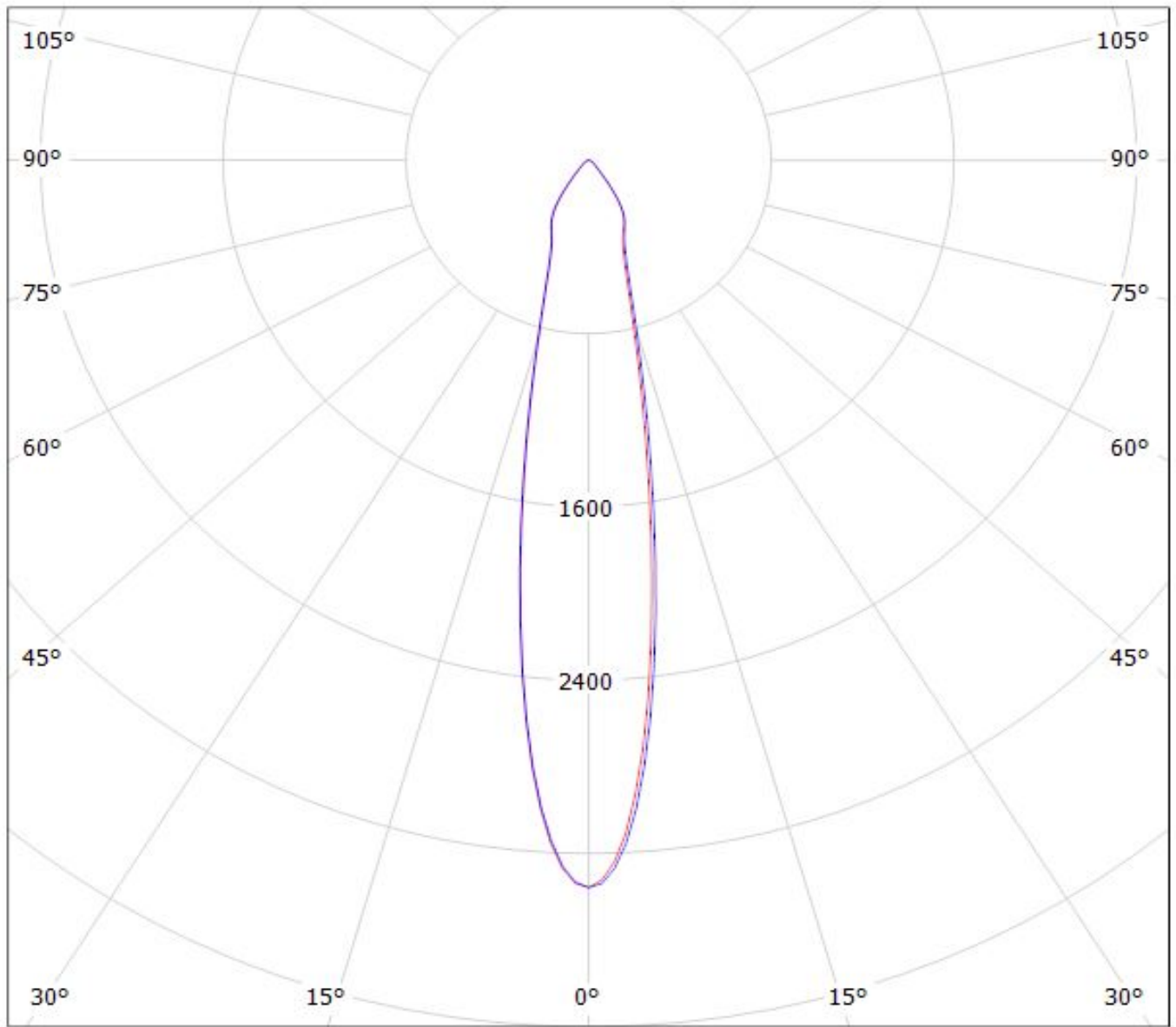

cd/klm

$\eta = 88\%$

— C0 - C180 — C90 - C270

Luminaire: LEDil Oy CN12483_MIRELLA-50-S-DL_(ZC6) Efficiency=83%
Lamps: 1 x Seoul ZC6 (SDW81F1C) 422lm @ 100mA CCT=3100K P=3.4W I=100mA

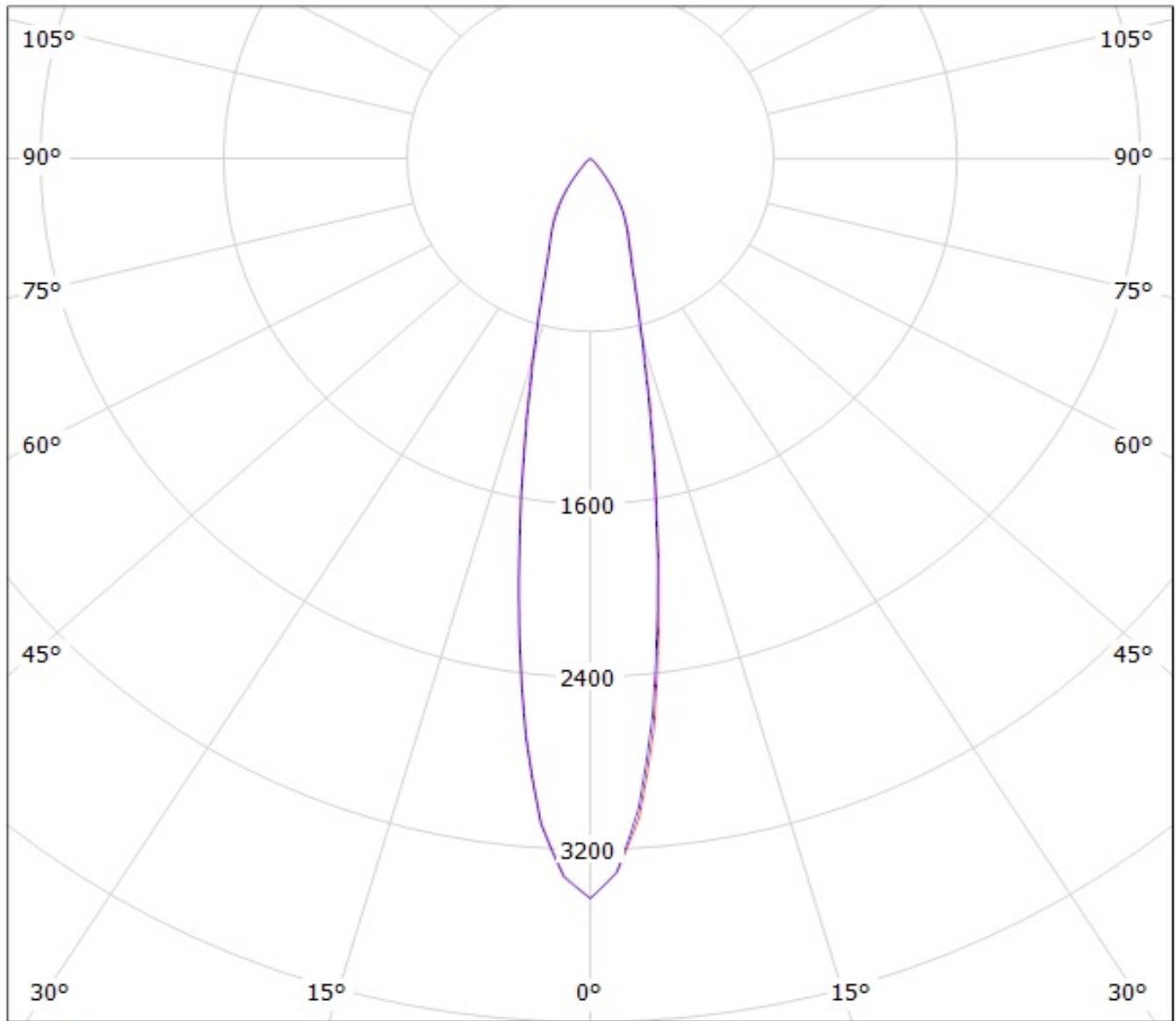

cd/klm

— C0 - C180

— C90 - C270

Luminaire: LEDiL Oy CN12483_MIRELLA-50-S-DL_(CLU700)

Lamps: 1 x CITIZEN_CLU700_(CLU700-100-2B8-273M2G1)_380.605lm@250mA_P=2.8002W_I=0.1001A

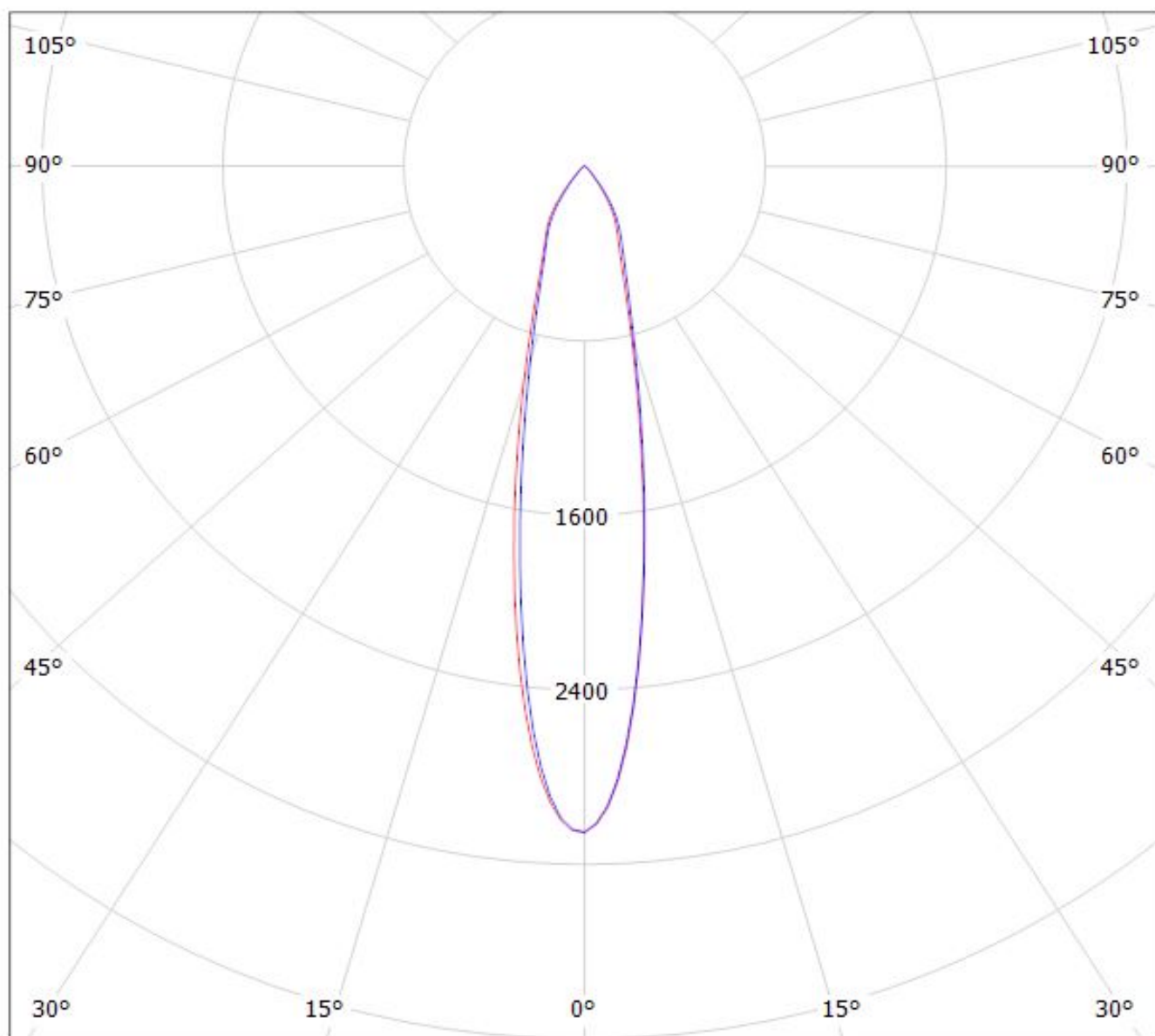

cd/klm

— C0 - C180

— C90 - C270

$\eta = 84\%$

Luminaire: Ledil Oy CN12483_MIRELLA-50-S-DL (NSBxL066A 930lm @ 250mA) Efficiency=86%
Lamps: 1 x NSBxL066A 930lm @ 250mA (NSBL066AE) CCT=3536K P=7,75W I=250mA

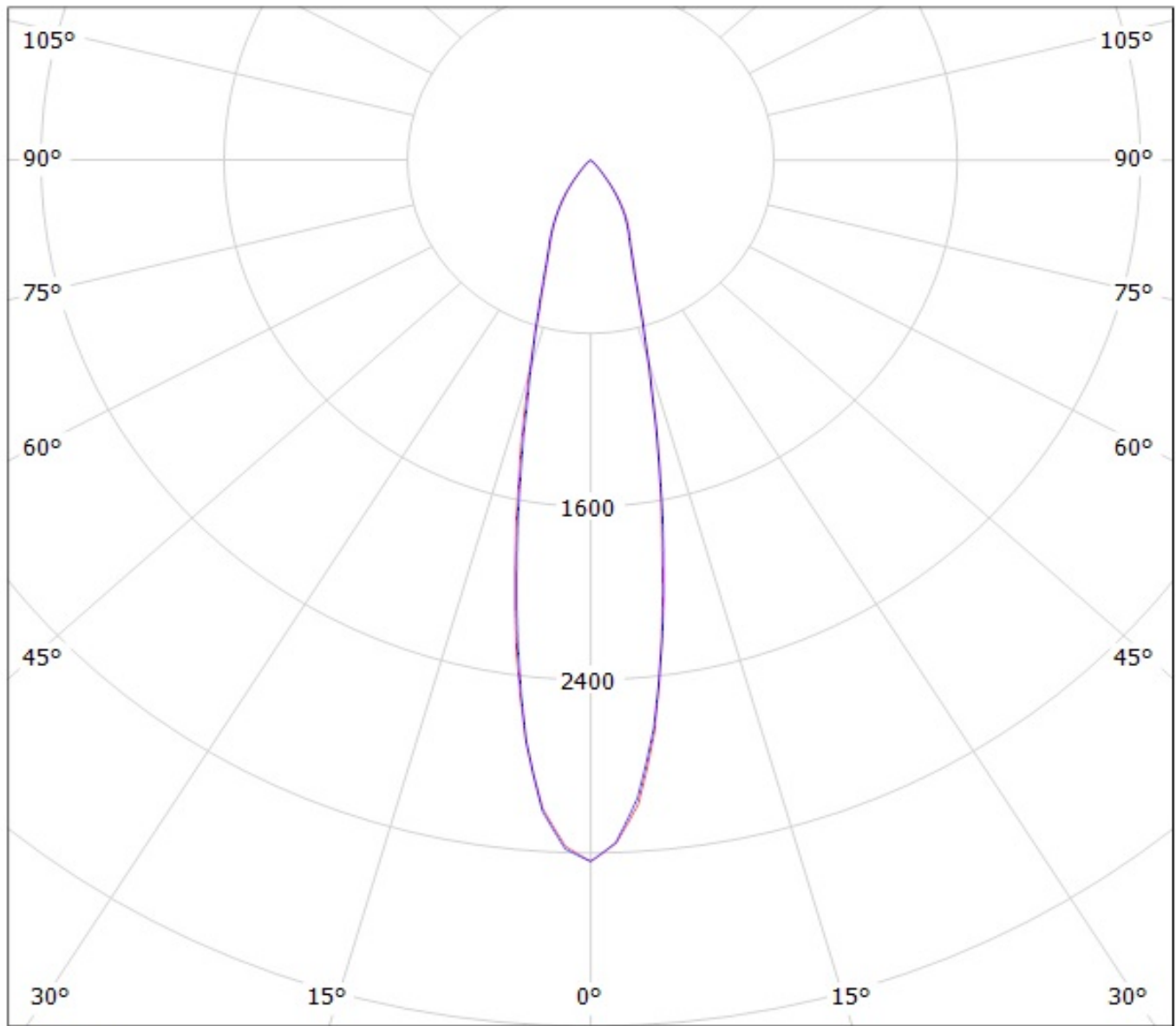

cd/klm

— C0 - C180 — C90 - C270

Luminaire: Ledil Oy CN12483_MIRELLA-50-S-DL_(Luxeon_CoB_1203) Efficiency= 85%
Lamps: 1 x Luxeon Cob 1203 (LHC1-3080-1203) 824lm @ 250mA CCT=3000K P=8.7W I= 250mA

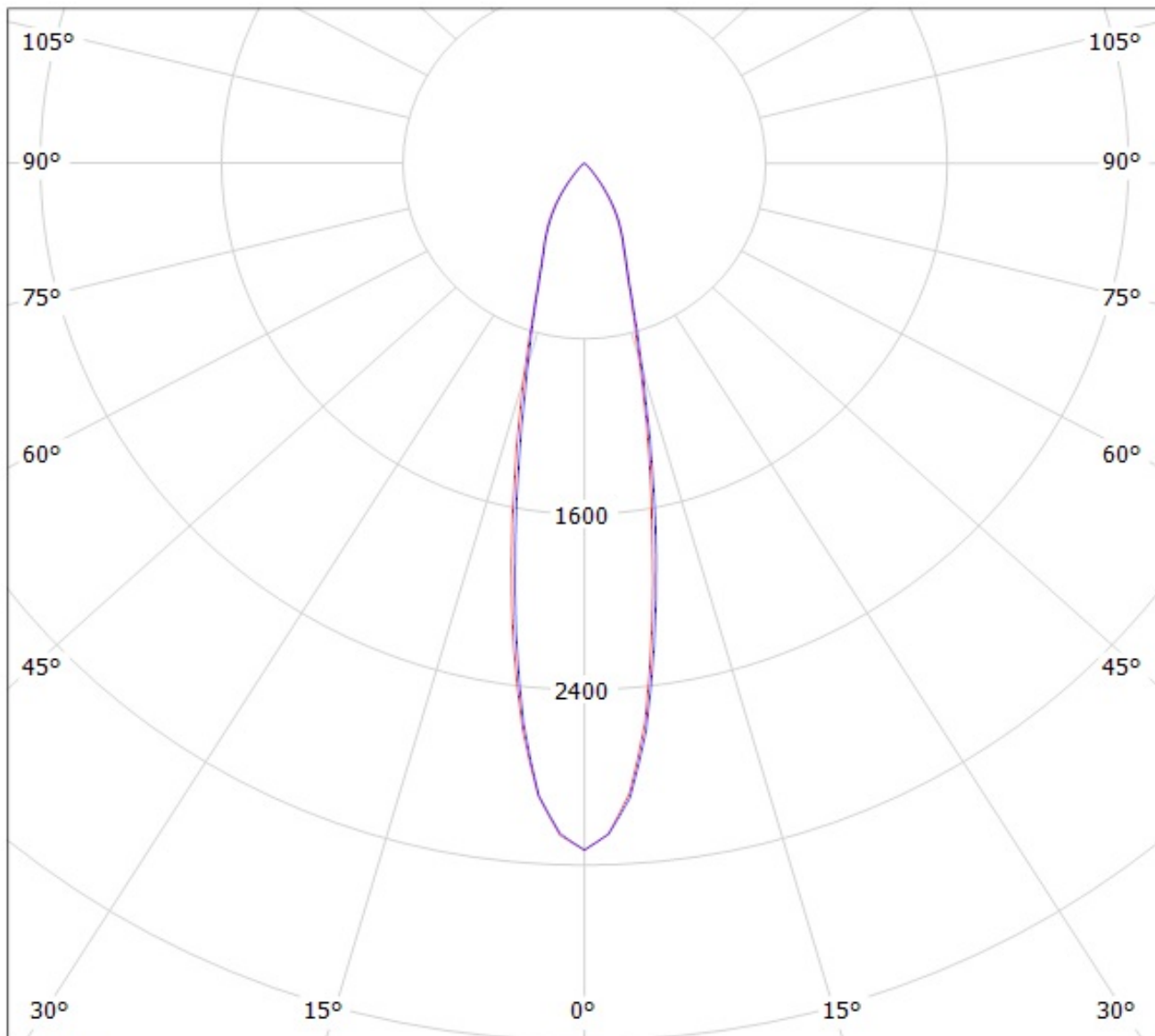

cd/klm

— C0 - C180 — C90 - C270

Luminaire: LEDiL Oy CN12483_MIRELLA-50-S-DL_(CXM-9)

Lamps: 1 x Luminus_XNOVA_CXM-9_(AA00)_974.083lm@240mA_P=8.27544W_I=240mA

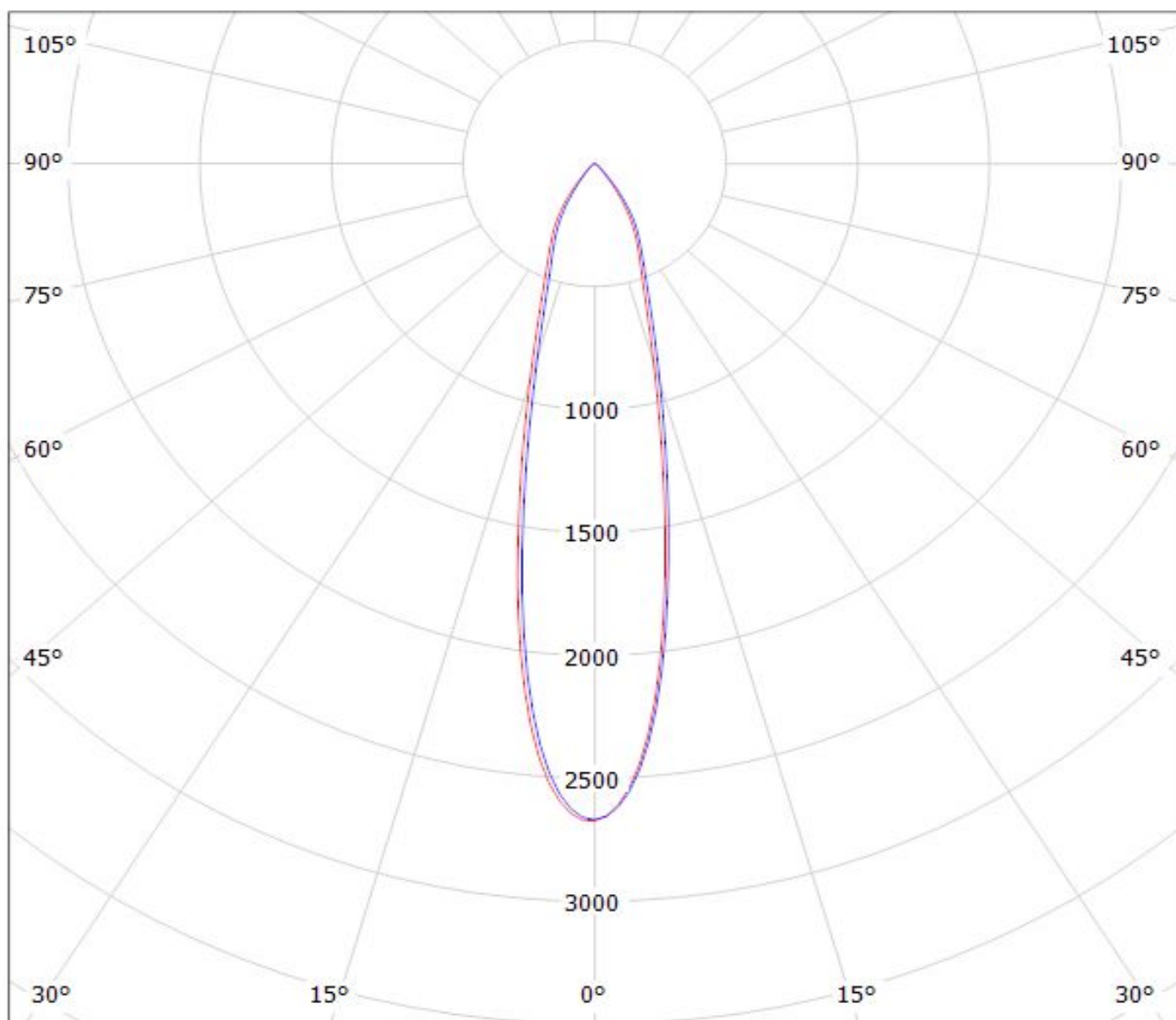

cd/klm

— C0 - C180

— C90 - C270

$\eta = 84\%$

Luminaire: Ledil CN12483_MIRELLA-50-S-DL_(CLU710)

Lamps: 1 x CITIZEN_CLU710_(CLU710-1204B8-273M2G1)_1212.66lm@250mA_P=8.5W_I=0.25A

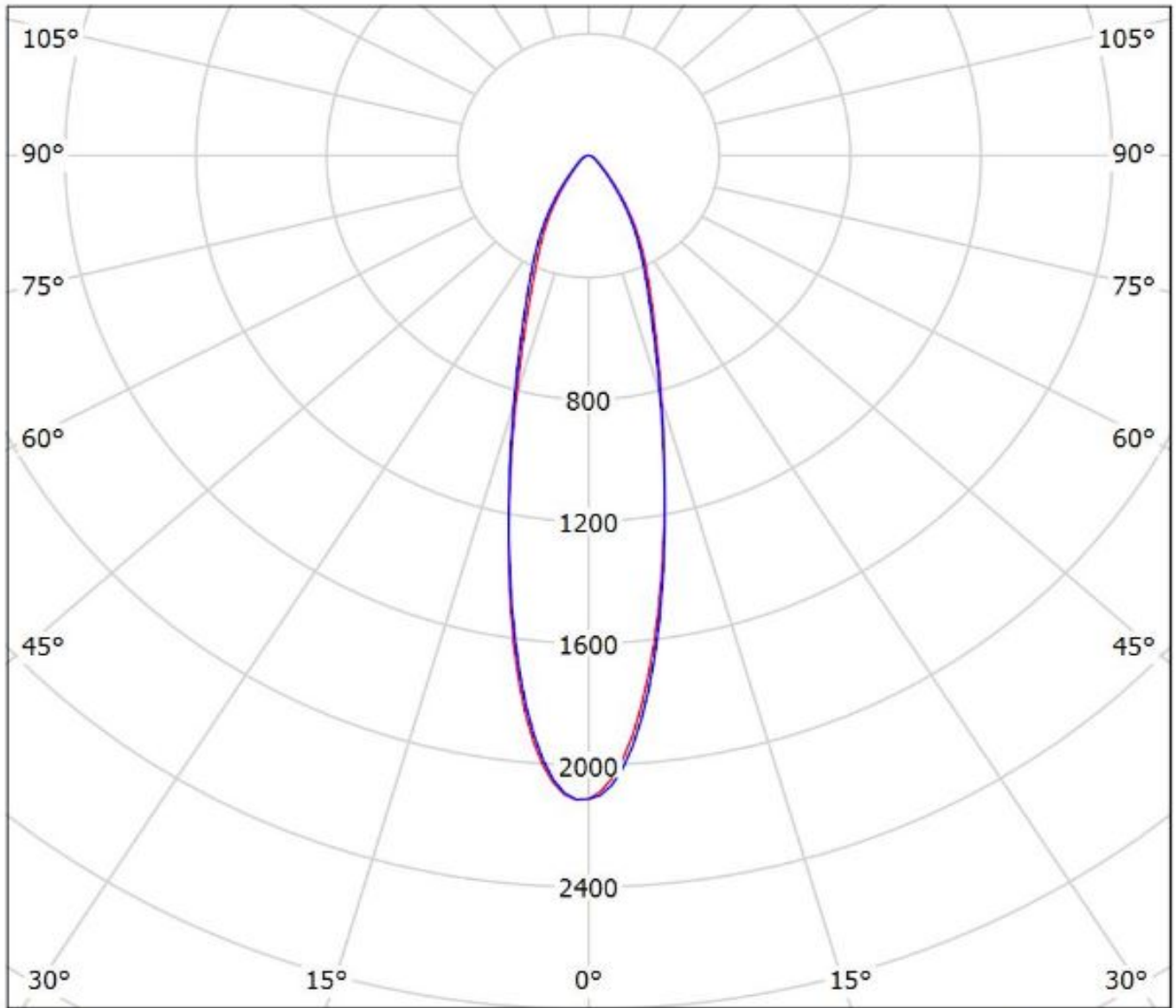

cd/klm

— C0 - C180

— C90 - C270

$\eta = 83\%$

Luminaire: Ledil Oy
Lamps: 1 x CN12483_MIRELLA-50-S-DL_(CLL028)

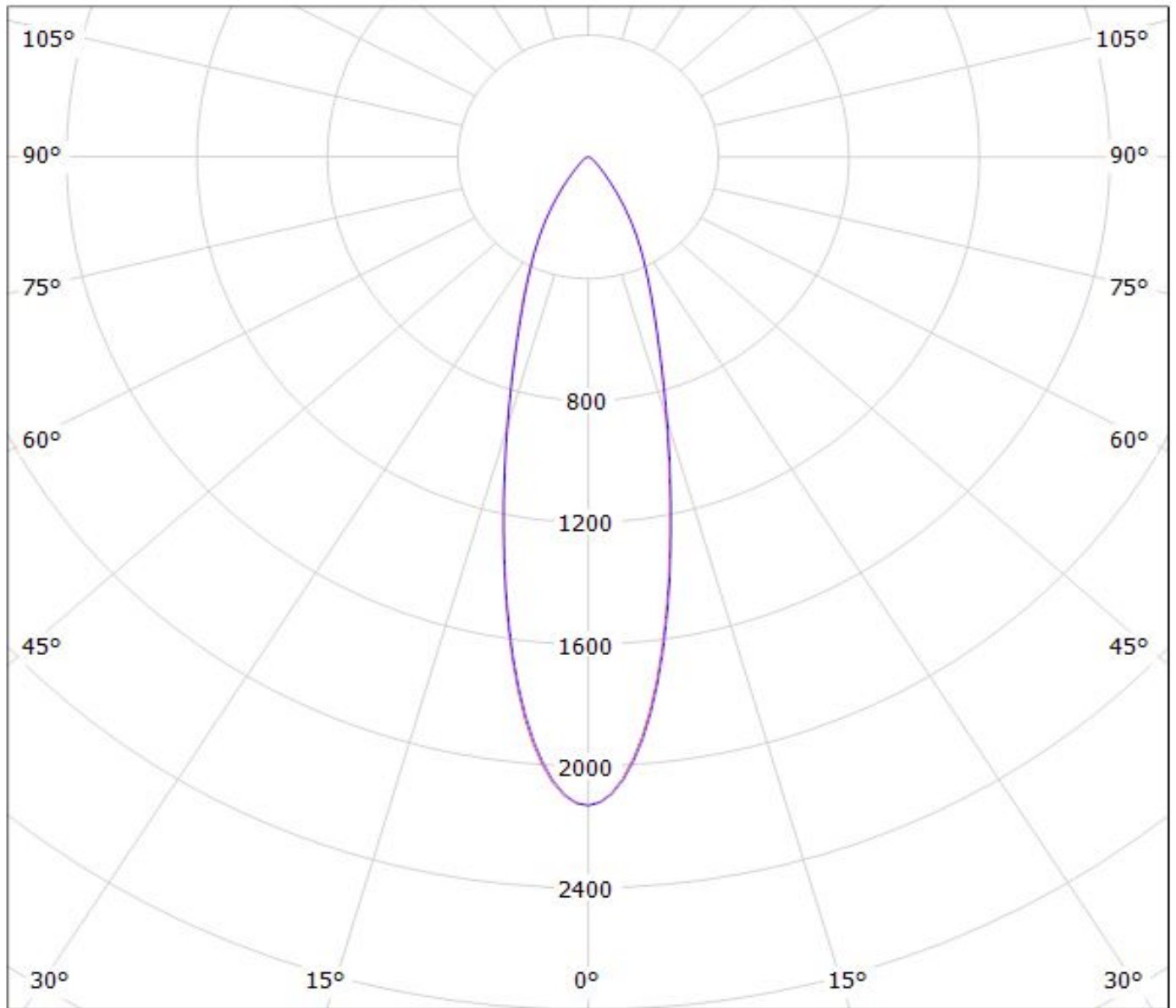

cd/klm

— C0 - C180 — C90 - C270

$\eta = 82\%$

Luminaire: LEDil Oy CN12483_MIRELLA-50-S-DL_(Soleriq_S13) Efficiency=83%
Lamps: 1 x Osram Soleriq S13 (GW KAGHB1.EM) 832lm @ 250mA CCT=3100K P=7.4W I=250mA

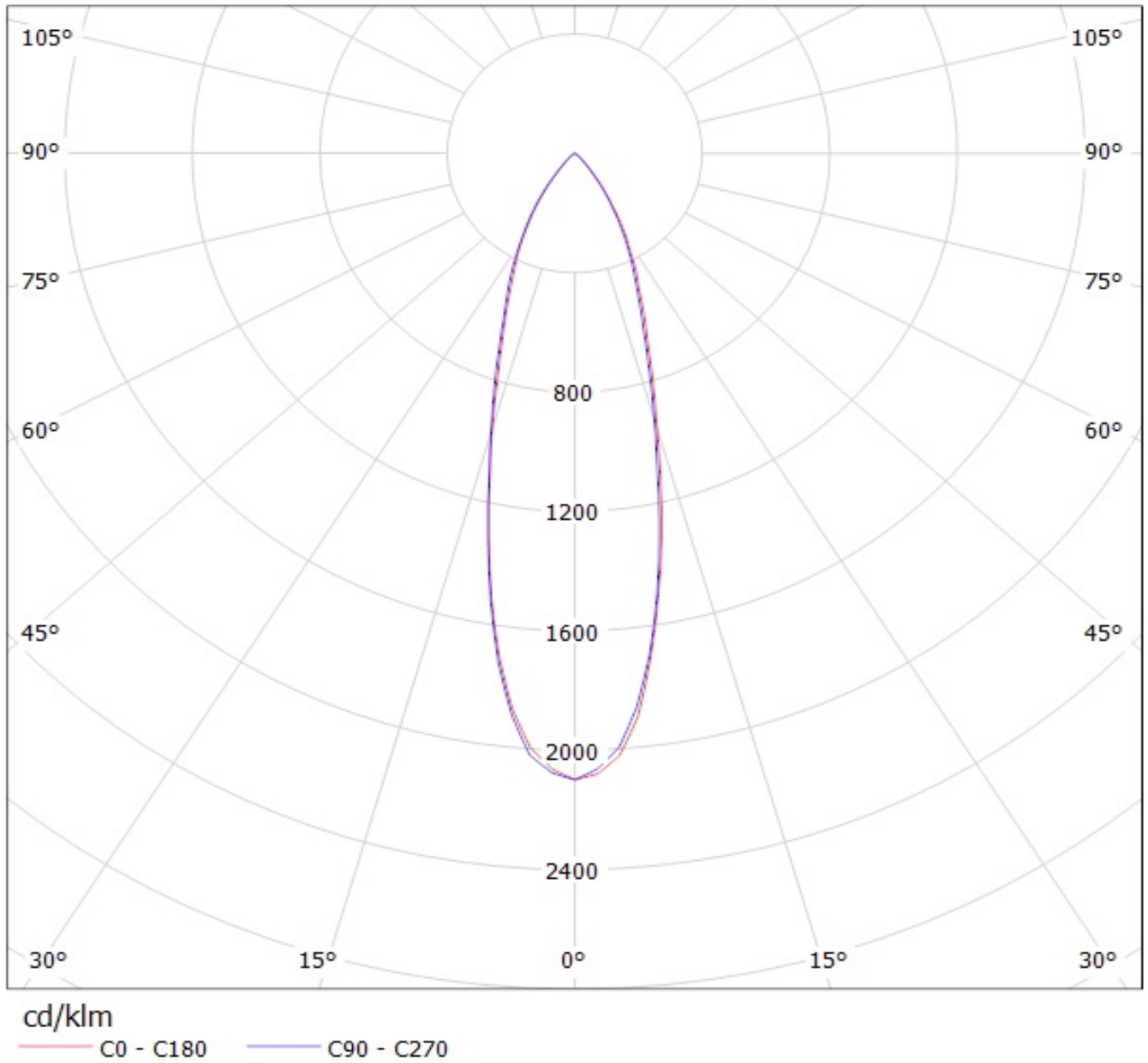

Luminaire: Ledil CN12483_MIRELLA-50-S-DL_(CLU720)
Lamps: 1 x CITIZEN_CLU720_(CLU720-1206B8-273M2)
_1298.17lm@250mA_CCT=2700K_P=8.3W_I=0.25A

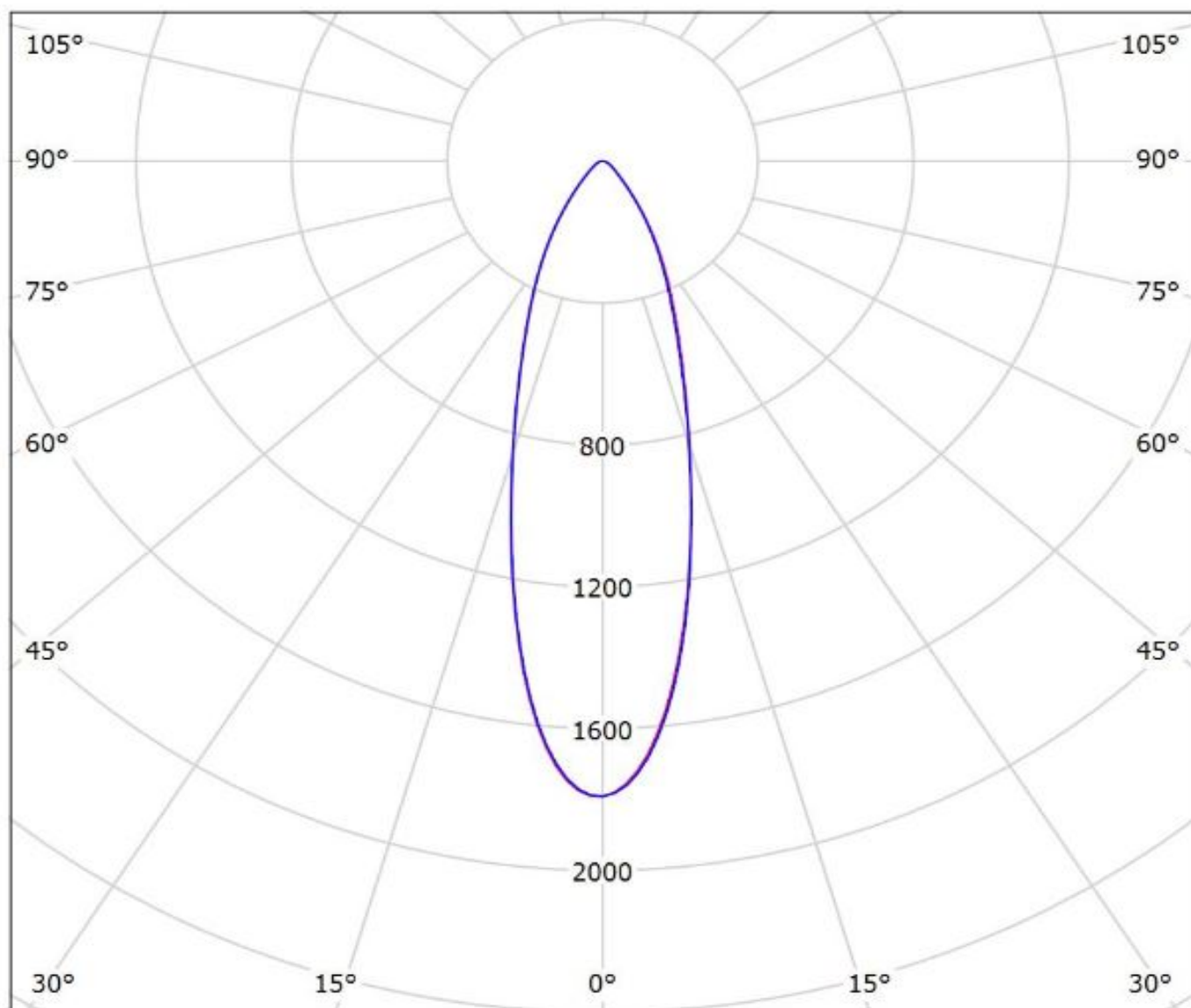

cd/klm

— C0 - C180 — C90 - C270

$\eta = 82\%$

NOTE: The typical divergence will be changed by different color, chip size and chip position tolerance. The typical total divergence is the full angle measured where the luminous intensity is half of the peak value.

GENERAL INFORMATION

- Product series especially designed & optimized for series of LEDs.
- Special care taken to make light distribution as uniform as possible.
- Fastening to PCB with appropriate adhesive. By clicking link below you can find Ledil recommended glue options.
http://www.ledil.com/datasheets/DataSheet_GLUES.pdf

Note! Due to use of high power COB's with this product, special attention to proper thermal design is highly recommended. LEDiL has no liability for direct, indirect or consecutive damages arising from the LEDiL products being used outside of the recommended temperature range.

NOTE 1: We advise customer to ensure the suitability and sufficiency of the bond in the end product. For example, mechanical stress, vibration and holes on the surface of the circuit board weaken the strength of the glue.

NOTE 2: All surfaces where glue is applied must be clean, dry and free from grease and dirt. If cleaning of PCB surfaces is needed, please follow strictly the cleaning instructions of your LED manufacturer -this is important as cleaning shall under no circumstances damage LEDs or other electronics components on the PCB.

Further note that optical components shall not be cleaned with any chemicals - only micro fiber cloth may be used to remove fingerprints or other traces from handling.